

# Technical Documentation



ELECTRIC MOTORS IN EXPLOSION - PROOF  
PROTECTION INCREASED SAFETY EExe  
FLAMEPROOF ENCLOSURE EExd

EX09EN



**ATB SEVER**  
Technology in Motion

# Vision



We set your ideas in motion. We do not merely manufacture motors, but instead turn the ambitious concepts of our customers into modern, innovative and reliable products, which are unique and point the way to the future. We bring our customers closer to their goals with reliability, creativity and flexibility.

## Business Units



Serial Motors



New Businesses



Home Appliances

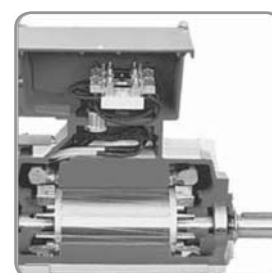

Project Motors

# CONTENTS

<b>CONTENTS.....</b>	<b>1</b>
<b>1. GENERAL INFORMATION .....</b>	<b>2</b>
1.1 INTRODUCTION.....	2
1.2 DESIGNATION OF DESIGN.....	2
1.3 STANDARDS AND DIRECTIVES.....	3
1.3.1 Review of basic standards and directives.....	3
1.3.2 Release, hazardous areas and zones .....	4
1.3.3 Temperature classes and groups of gases.....	4
1.4 MECHANICAL CHARACTERISTICS .....	5
1.4.1 Mounting arrangements of electric motors.....	5
1.4.2 Shaft extension .....	6
1.4.3 Balancing and vibrations.....	6
1.4.4 Noise .....	6
1.4.5 Surface protection .....	6
1.4.6 Rating plates .....	6
1.5 ELECTRICAL CHARACTERISTICS.....	6
1.5.1 Voltage and frequency .....	6
1.5.2 Terminals and winding connection.....	7
1.5.3 Output.....	7
1.5.4 Overloading and starting .....	7
1.5.5 Insulation and heating .....	7
1.5.6 Inverter fed motors .....	7
<b>2. MOTORS IN PROTECTION OF INCREASED SAFETY EExe.....</b>	<b>8</b>
2.1 EXPLOSION-PROOF PROTECTION OF INCREASED SAFETY EExe.....	8
2.2 DESIGN, TAKEOVER AND APPLICATION OF MOTORS IN PROTECTION EExe.....	8
2.2.1 Design .....	8
2.2.2 Overload protection.....	8
2.2.3 Application.....	9
2.2.4 Technical acceptance and certification .....	9
2.3 MECHANICAL DESIGN.....	9
2.3.1 Mechanical protection .....	9
2.3.2 Tabular review of constructional materials.....	9
2.3.3 Bearing arrangement .....	9
2.4 TECHNICAL DATA FOR SELECTION.....	11
2.6 PARTS .....	19
<b>3. MOTORS IN PROTECTION OF FLAMEPROOF ENCLOSURE EExd.....</b>	<b>22</b>
3.1 EXPLOSION-PROOF PROTECTION FLAMEPROOF ENCLOSURE EExd .....	22
3.2 DESIGN .....	23
3.2.1 Forms, mechanical protection, constructional characteristics and materials of electric motor EExd.....	23
3.2.2 Terminal box and assembly drawings.....	23
3.2.3 Bearing arrangement .....	28
3.3 TECHNICAL DATA FOR SINGLE-SPEED MOTORS SELECTION.....	29
3.4 TECHNICAL DATA FOR TWO-SPEED MOTORS SELECTION .....	31
3.5 OUTLINE DRAWINGS .....	32
3.6 PARTS .....	40
<b>4. QUESTIONNAIRE FOR EEx MOTORS .....</b>	<b>41</b>

# 1. GENERAL INFORMATION

## 1.1 INTRODUCTION

Explosion-proof three-phase induction electric motors in this catalogue, refer to the design of increased safety - **EExe** and flameproof enclosure - **EExd**. These motors are applied in industrial plants, in which danger can occur from explosion of inflammable vapours or gases (e.g. chemical industry, petrochemical industry, oil refinery, textile industry) and also in mines, which are dangerous because of methane and inflammable dust.

Design **increased safety is in conformity with standards** EN 50014 and EN 50019 while the design **flameproof enclosure** is in conformity with EN 50014 and EN 50018.

## 1.2 DESIGNATION OF DESIGN

Designation of electric motors manufactured by ATB SEVER according to the mentioned designs is done as follows:

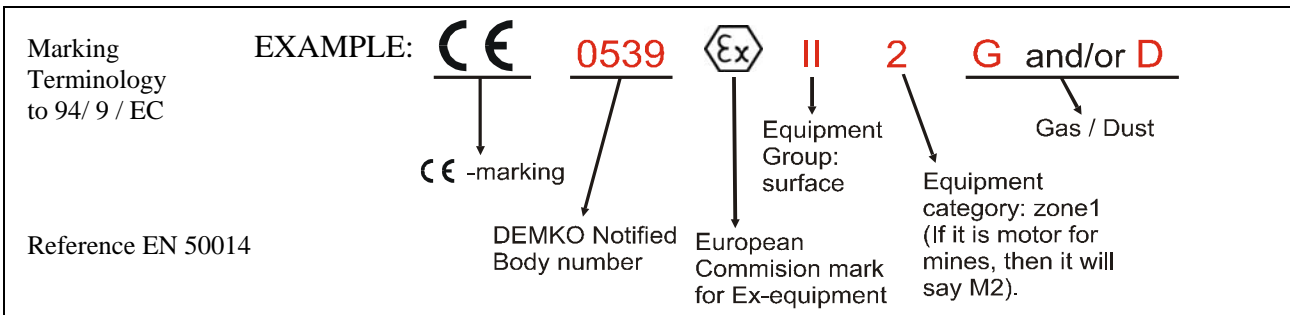
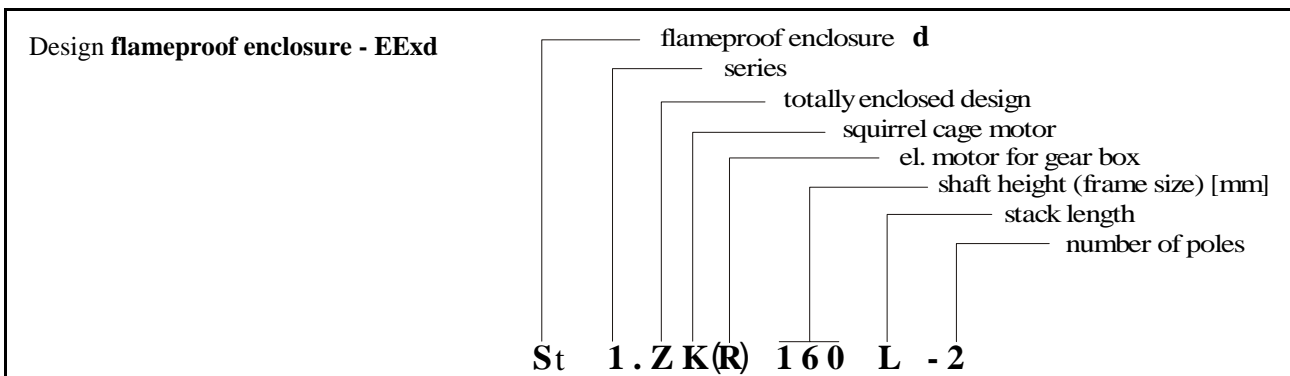
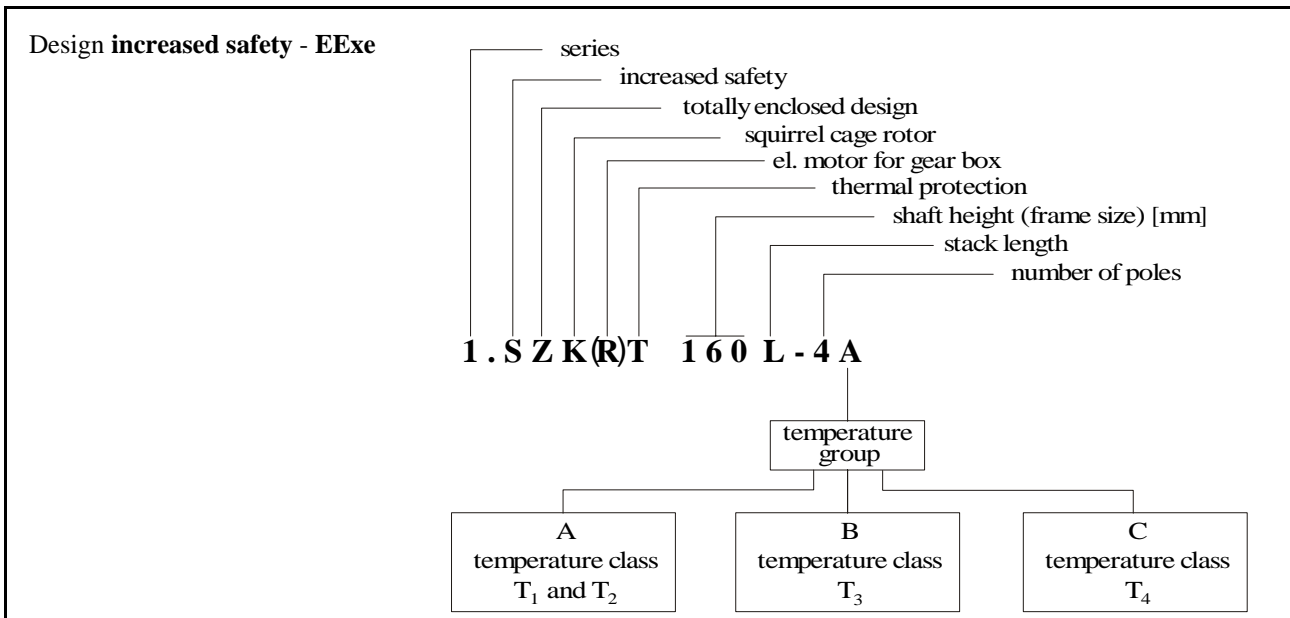

## 1.3 STANDARDS AND DIRECTIVES

## 1.3.1 Review of basic standards and directives

	International referent standards		National standards		
	IEC International Electrotechnical Commission	EN-CENELEC European committee for el. tech.norms.	DIN/VDE- German industry norms- Association of German electric technicians	BS- British standards	CEI- Electrotechnical committee of Italy
Rotating electrical machines					
Rotating electrical machines, Rating and performances	IEC 60034, part 1 IEC60085	EN 60034-1	DIN EN 60034-1/ VDE 0530, part 1	BS 4999: P1 BS 4999: P69	CEI 2-3355
Methods for determining losses and efficiency	IEC 60034, part 2	EN 60034-2	DIN EN 60034-2/ VDE 0530, part 2	BS 4999-34	CEI2 -6
Degree of mechanical protection	IEC 60034, part 5	EN 60034-5	DIN EN 60034-5/ VDE 0530, part 5	BS 4999: P20	CEI 70-1519
Methods of cooling	IEC 60034, part 6	EN 60034-6	DIN EN 60034-6/ VDE 0530, part 5	BS 4999: P21	CEI 2/No-454
Mounting arrangements	IEC 60034, part 7	EN 60034-7	DIN EN 60034-7/ VDE 0530, part 5	BS 4999: P22	CEI-UNEL 05513
Terminal markings	IEC 60034, part 8	EN 60034-8	DIN/VDE 0530, part 8	BS 4999: P23	CEI 2-8V1 No 5628
Noise limits values	IEC 60034, part 9	EN 60034-9	DIN EN 60034-9/ VDE 0530, part 9	BS 4999: P51	Draft of Italian standard P288
Starting performances	IEC 60034, part 12	EN 60034-12	DIN/VDE 0530, part 12	—	—
Mechanical vibrations, limit values	IEC 60034, part 14	EN 60034-14	DIN/VDE 0530, part 14 DIN ISO 2373	BS 4999: P50	Draft of Italian standard P288
Mounting dimensions	IEC 60072	EN 60072	DIN 42673, part 3	BS 4999: P10	CEI-UNEL 13117
Electrical apparatus for explosive gas atmospheres - General provisions	IEC 60079, part 0	EN 50014	DIN EN 50014	BS 5501: P1	CEI 31-8459
Electrical apparatus for explosive gas atmospheres - Flame-proof enclosure EExd	IEC 60079, part 1	EN 50018	DIN EN 50018/ VDE 0171, part 5	BS 5501: P5	CEI 31-1472
Electrical apparatus for explosive gas atmospheres - increased safety EExe	IEC 60079, part 7	EN 50019	DIN EN 50019/ VDE 0171/ part 6	BS 5501: P6	—

The explosion-proof protection motors covered by the new Directive 94/9/EC must also meet the requirements of other relevant Directives: Low Voltage Directive 73/23/EEC, modified by 93/68/EEC; Electromagnetic Compatibility Directive 89/336/EEC, modified by 92/31/EEC and 93/68/EEC and Machinery Directive 98/37/EC.

### 1.3.2 Release, hazardous areas and zones

The source of release is the place which contains inflammable medium or from which the inflammable medium goes out. Inflammable medium is considered to be, as follows:

- ◆ the explosive mixture of gases, vapours and dust,
- ◆ medium-air mixture can make explosive atmosphere.

Regarding the way of formation and duration of explosive mixtures, sources of release are classified as permanent, primary and secondary sources of release.

Permanent sources of release contain or emit permanently inflammable medium or explosive mixture into the surrounding space.

Primary sources of release, occasionally, at normal operation, contain or emit inflammable medium or mixture into the surrounding space.

Secondary sources of release, only under abnormal circumstances, i.e. in case of damage of the plant or incorrect technological process, emit inflammable medium or mixture into the surrounding space.

The sources of release can be multi-stage, and in determining hazardous area every stage will be taken into consideration separately.

The hazardous area is the space in which explosive atmosphere is present or can be expected. Its presence in the certain quantity requires special measures of precaution, with regard to assembly performance and use of electric devices, tools, machines and accessories which sparks, make electric arc or have heated surfaces.

Classification by group and category for mining and surface industry is defined according corresponding Standards and Directives.

### 1.3.3 Temperature classes and groups of gases

In order to occur explosions the existing mixture must be ignited initially. For initial ignition its source must have enough power and temperature above the minimum temperature of ignition of this mixture. Gases and vapours are classified in the following temperature classes, on the basis of ignition temperature measured by a method and with a device in accordance with the corresponding standard.

Temperature class	Max. surface temperature
T1	450 °C
T2	300 °C
T3	200 °C
T4	135 °C
T5	100 °C
T6	85 °C

This standard provides data of group of gases, temperature classes, max. experimental safety gap, ignition temperature and ratio of minimal ignition current and minimal ignition current of laboratory methane, for 156 gases and vapours, which can form explosive mixtures. The most hazardous gases are: acetylene, hydrogen, carbon disulfide, are in the group C; ethylene, methyl acrylate, dimethyl ethane and some other gases are in the group B; while most of them are in the group A (methane, ethane, amyl-acetone, ammonia, benzol, butane, propane and masout).

## 1.4 MECHANICAL CHARACTERISTICS

### 1.4.1 Mounting arrangements of electric motors

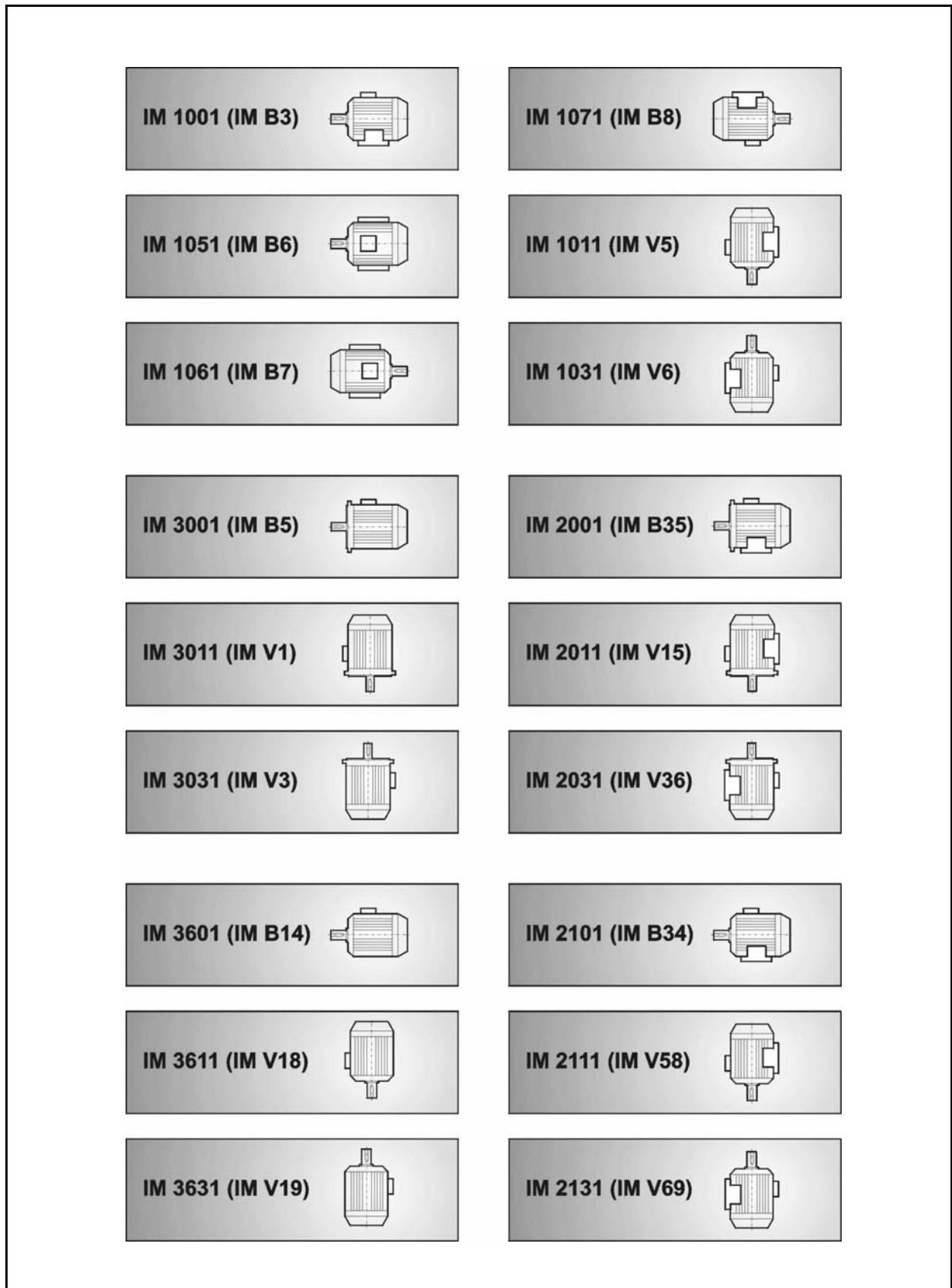

### 1.4.2 Shaft extension

Motors are manufactured with one cylindrical shaft extension. On a special request, they can be manufactured also with two shaft extensions, with a tape shaft extension and with other special forms. The dimensions of shaft extension, keys and keyway dimensions are in conformity with the IEC 60072-1. The dimensions of tapped hole in shaft are shown in the following table. In order to keep load of bearings and of shaft extension within the allowed limits, there must be paid attention to radial and axial forces and to the type of transmission from a motor to a working machine.

**Tapped hole in shaft**

Frame size	Drive side	Fan side
71	M5	M4
80	M6	M5
90	M8	M8
100	M10	M10
112		
132	M12	M12
160	M16	M16
180		
200		
225	M20	M20
250		
280		
315		

### 1.4.3 Balancing and vibrations

All motors are balanced dynamically with half key on a drive shaft extension in quality which corresponds to DIN ISO 2373. Measurement evaluation and limits of vibration are according to IEC 60034 part 14. The data are shown in the following table. Motors with vibration degree "R" (reduced) or "S" (special) are available on a special request.

Indicated speed [mms <sup>-1</sup> ]	Max. effective value of vibration speed for shaft height H [mm]			
	Machines measured in a state of free suspension			Rigid mounted
	56 ≤ H ≤ 132 [mm/s]	132 < H ≤ 225 [mm/s]	H > 225 [mm/s]	H > 400 [mm/s]
≥ 600 ≤ 1800	1,8	1,8	2,8	2,8
> 1800 ≤ 3600	1,8	2,8	4,5	2,8

### 1.4.4 Noise

Motors satisfy the noise level emission in accordance to standard IEC 60034, Part 9.

### 1.4.5 Surface protection

Final surface protection of motor is performed by alkyd color, type RAL 7001. Motors for exploitation in special atmospheric conditions according to IEC 529 (EN 60529) are available on a special request.

### 1.4.6 Rating plates

Rated and inspection data are in the same rating plate fixed on the enclosure. A duplicate of the plate is located in the cover of the terminal box. The plates are made of stainless steel.

## 1.5 ELECTRICAL CHARACTERISTICS

### 1.5.1 Voltage and frequency

Motors are designed for rated voltage 400 V ±10%, 50 Hz according to IEC 60038. Motors up to 1,5 kW are connected in star (Y), and above that in delta (Δ). On a special request motors can be designed for other voltages as well, as it is shown in the following table, up to 690 V and for frequency from 42 to 60 Hz.



Voltage [V]	Frequency [Hz]
380	50
400	
415	
500	
440	60
460	
480	

### 1.5.2 Terminals and winding connection

Motors are manufactured with six winding terminals which are marked as: U1, V1, W1, U2, V2, and W2. Stator winding are made in connection star (Y) for motors up to 1.5 kW and delta ( $\Delta$ ) for other motors. Motors in delta connection need special measures for motor protection.

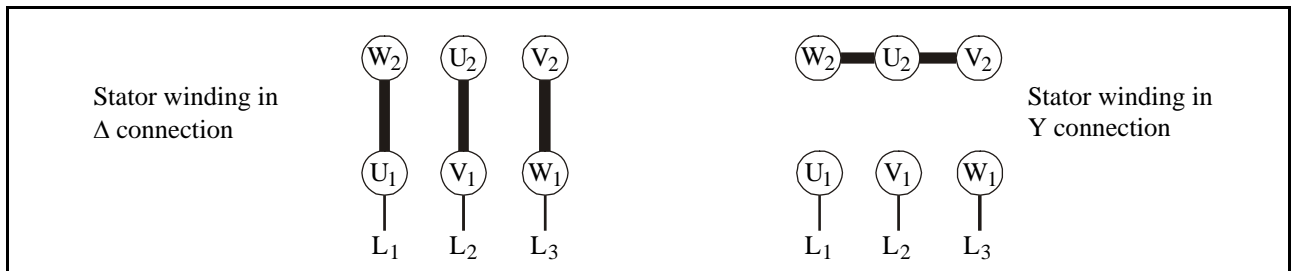

Two-speed motors with a speed ratio 2:1 are made with Dahlander windings, while the motors with a pole ratio 4/6 or 8/6 are made with two separate stator windings in star connection.

### 1.5.3 Output

The rated motor outputs, given in selection tables are for continuous running duty. This means that motors have to be connected to the network of rated voltage and frequency, while ambient temperature must not exceed 40 °C and the altitude must be up to 1000 m.

### 1.5.4 Overloading and starting

According to IEC 60034-1, motors can be overloaded, meaning that motors heated to an operating temperature can withstand current equal to 1.5 times the rated current for not less than 2 minutes. The same way they can be overloaded by the torque 1.6 times the rated one for 15 seconds without stalling or abrupt change in speed.

Overcurrent relays, which must be applied in conformity with the regulations for hazardous areas, allow limited starting time. This means that flywheel masses, which accelerate during start, are also limited.

### 1.5.5 Insulation and heating

Windings are designed with insulation of thermal class F. A motor temperature rise satisfies both thermal class B, which is 80 K over the maximum ambient temperature of 40°C, and temperature class T4.

### 1.5.6 Inverter fed motors

Motors are suitable for operation by frequency inverter since the winding insulation of the motors endures certain voltage overloading. Generally, motors operated by inverters have higher noise level. During operation by inverter, the motors have additional load losses, which affect the output torque, depending on a speed ratio, characteristics of working machine, type of cooling (self-ventilated or an additional, external fan) and on the type of inverter, as well. Therefore when placing an order it is necessary to note that the motor will be operated by inverter. It is also necessary to define the speed ratio and characteristics of the working machine  $P=f(n)$  or  $M=f(n)$ .

## 2. MOTORS IN PROTECTION OF INCREASED SAFETY EExe

### 2.1 EXPLOSION-PROOF PROTECTION OF INCREASED SAFETY EExe

Concerning electric motors in explosion-proof protection of increased safety "EExe" there have been taken measures, which prevent occurrence of sparking, electric arcs or excessive temperatures during operation of machine.

### 2.2 DESIGN, TAKEOVER AND APPLICATION OF MOTORS IN PROTECTION EExe

#### 2.2.1 Design

Electric motors are in an enclosure which protects against penetration of dust, particles and other impurities. Besides the enclosure, protection is consisted of:

- ◆ good insulating material (non-hygroscopic, thermostable, mechanically strong, non-flammable, self-extinguishing and resistant to leakage currents)
- ◆ good mechanical protection (terminal box IP54, enclosure IP44)
- ◆ allowed heating in the limits of temperature class T1 - T4; insulation class F (H class on a special request)
- ◆ winding impregnation (vacuum system and submerging)
- ◆ expert supervision and handling

#### 2.2.2 Overload protection

Basic protection against overloading is an overcurrent protecting device (e.g. a motor protection switch). Besides current control in normal operation in case of locked rotor, the protection device also has to disconnect a motor within time  $t_E$ , which is given in a rating plate of the motor. Triggering characteristics of a trigger or of a relay with thermal tensioning are based on the initial temperature of 20°C. The applied protecting device (trigger or relay) must have a suitable characteristics – current ratio/time, which provides time of disconnection in the function of the motor current ratio –  $I_p/I_N$ . In addition, the protection device must have the possibility of connecting / disconnecting currents higher than the locked-rotor current  $I_p$ . The current dependant protecting devices are effective only with continuous (non-intermittent) duty and normal starting conditions, which do not cause overheating. For difficult starting conditions and for intermittent duties, the special protecting devices must provide that limit temperatures are never exceeded (during starting, too). It is

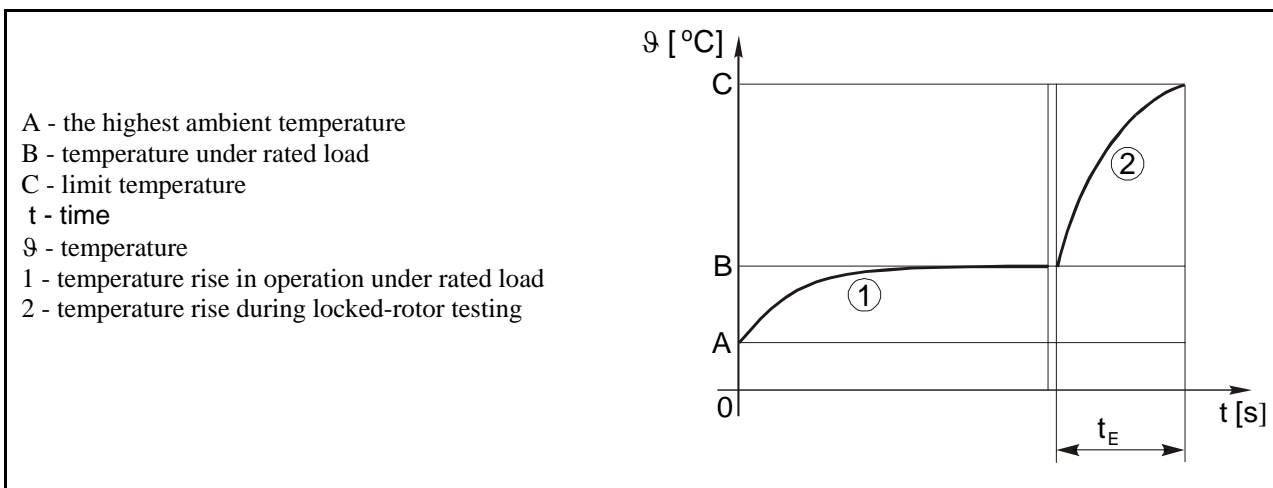

considered that there are difficult starting conditions, if a motor protecting device disconnects the motor before it reaches its rated speed. The  $t_E$  time taken for windings, when carrying the locked-rotor current  $I_p$ , to be heated up from the temperature reached in rated operation and at maximum ambient temperature to the limiting temperature. The  $t_E$  time is never less than 5 seconds. Appropriate protecting device to disconnect the motor within the  $t_E$  time is essential.

In case of difficult starting conditions, either motors of special design or double-stage overcurrent protection in combination with a relay for automatic control of speed and starting time are being used. Devices for direct control of winding temperature with sensors placed in the winding (e.g. PTC sensors) can also be applied,

but performance of such protection must be proved by testing together with a motor for all duty conditions (starting, continuous operation, disturbances, locked rotor). This is indicated in a suitable way.

In case of intermittent duty, heating is supervised by continuous secondary protection with two, three or more time constants, depending on the motor output.

### 2.2.3 Application

The motors can be applied in hazardous areas, where explosive atmosphere, such as mixtures of gases, fumes or vapour occur occasionally, but in accordance with temperature class rated in a motor rating plate. Valid technical regulations, which determine the installation of motor in hazardous areas, are to be paid attention.

### 2.2.4 Technical acceptance and certification

Technical acceptance and certification of motor in explosion-proof protection is performed according to defined procedures of authorized institutions and low regulations. ATB SEVER has certified its products both in the Yugoslav authorized institution - FEDERAL INSTITUTION for STANDARDIZATION, Belgrade, and in Danish authorized institution DEMCO, Denmark.

## 2.3 MECHANICAL DESIGN

### 2.3.1 Mechanical protection

Motors are designed in mechanical protection IP55 (IEC 60034-5 and EN 60034-5).

### 2.3.2 Tabular review of constructional materials

Frame size	Constructional elements of electric motor						
	Stator frame	Feet	Stator cover	Fan cover	Fan for both way rotation		Terminal box
					2p=2	2p=4,6,8	
71	Aluminium alloy			steel		polypropylene	together with frame
80							Aluminium alloy
90							
100							
112							
132	cast iron				Aluminium alloy	Aluminium alloy	
160							
180							
200							
225							
250							
280							
315	Aluminium alloy						

### 2.3.3 Bearing arrangement

The technical solution of bearing arrangement provides even and long-term operation of a motor. Characteristics and dimensions of bearings are shown in the Table 1. on page 10.

Table 1. - Bearings

Type	Drive end	Opposite end		Grease for re-lubrication		Amount of grease		Time of re-lubrication [h]			
				Insulation class				Number of poles			
		Horizontal design	Vertical design	B, F	H	[g]	[cm <sup>3</sup> ]	2	4	6	8,10,12
1.SZK 63	6002 2Z C3	6002 2Z C3		For life lubricated							
1.SZK 71	6203 2Z C3	6203 2Z C3									
1.SZK 80	6204 2Z C3	6204 2Z C3									
1.SZK 90	6205 2Z C3	6205 2Z C3									
2.SZK 100	6206 2Z C3	6206 2Z C3									
2.SZK 112	6206 2Z C3	6206 2Z C3									
1.SZK 132 M, L	6208 2Z C3	6208 2Z C3									
1.SZK 160 M, L	6210 2Z C3	6210 2Z C3									
1.SZK 180 M, L	6310 C3	6310 C3									
1.SZK 200 L	6312 C3	6312 C3									
1.SZK 225 M, S	6313 C3	6313 C3									
1.SZK 250 M	6314 C3	6314 C3									
1.SZK 280 M, S	NU 216	6216 C3									
1.SZK 315 M, S	NU 217	6217 C3									
SZK 315 M, S	6317 C3	6317 C3									
				LITHIUM GREASE	SILICONE GREASE	No re-lubrication	10000	11500			
						27	34	2500	5900	10500	13000
						19	24	1400/ 2800	3500/ 7000	5200/ 10500	7000/ 12500
						22	28			4300/ 9500	6000/ 12000
						37	46	1900	5500		

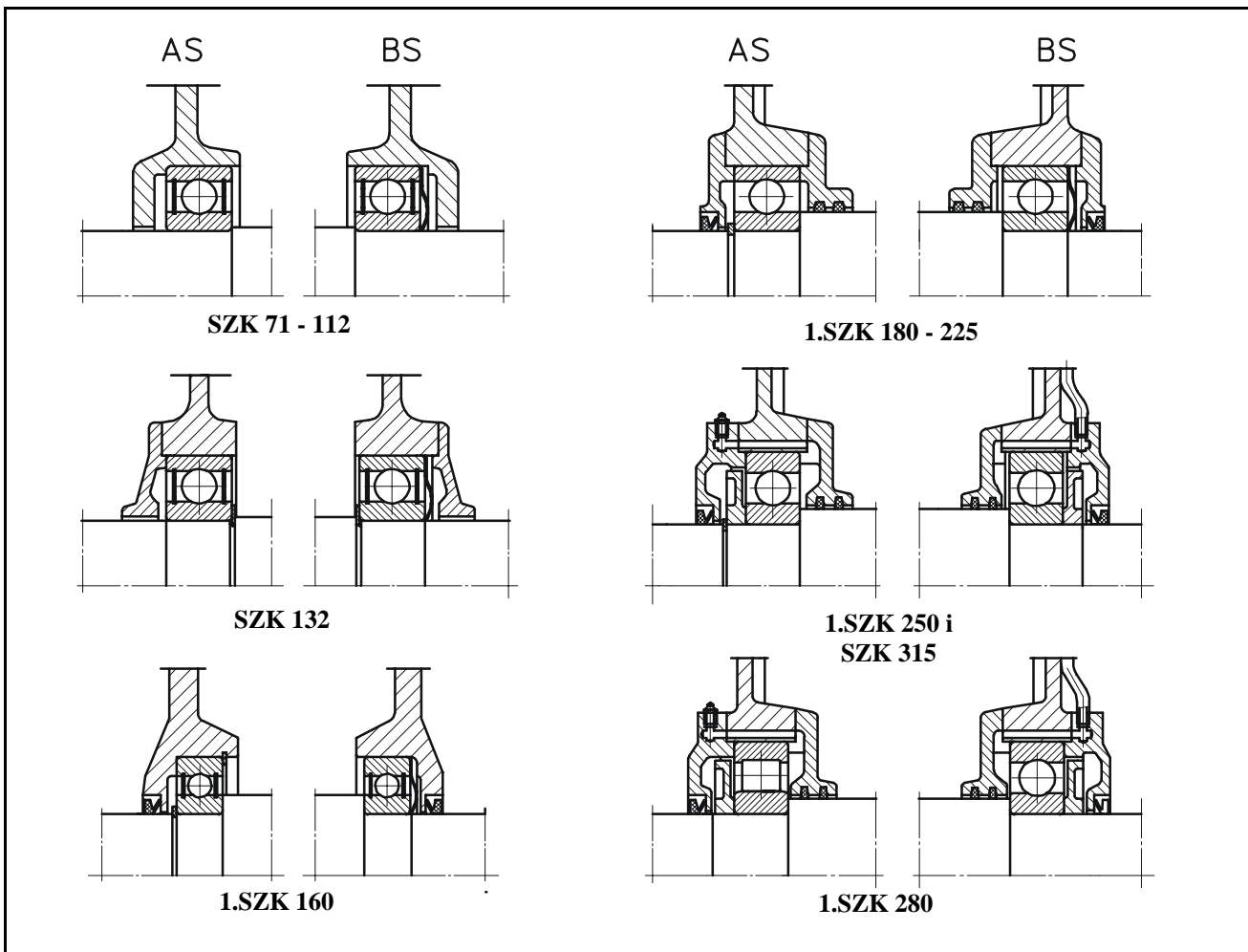

Bearing arrangement of electric motor in increased safety EExe

## 2.4 TECHNICAL DATA FOR SELECTION

3000 min<sup>-1</sup>, 400 V, 50 Hz, Insulation class: F, Mechanical protection: IP 55, Temperature class: T1-T4.

Type	Output [kW]			n [min <sup>-1</sup> ]	η [%]	cos φ	I <sub>N</sub> [A]	M <sub>N</sub> [Nm]	I <sub>P</sub> / I <sub>N</sub>	M <sub>P</sub> / M <sub>N</sub>	M <sub>m</sub> / M <sub>N</sub>	t <sub>E</sub> [s]			KR	J [kgm <sup>2</sup> ]	Mass [kg]	
	T1,T2	T3	T4									T1,T2	T3	T4				
1.SZK 71	A-2A	0,37	0,37	-	2750	63	0,81	1,05	1,3	3,5	2,0	-	30	30	10	16	0,00023	5,4
	A-2B	0,32	0,32	0,32	2760	63	0,82	0,90	1,1	3,8	2,3	-	-	-	12	16	0,00023	5,4
	B-2A	0,55	0,55	-	2760	69	0,81	1,43	1,9	4,2	2,2	-	18	18	9	16	0,00033	6,3
	B-2B	0,42	0,42	0,42	2780	70	0,83	1,04	1,4	5,1	2,9	-	-	-	10	16	0,00033	6,3
1.SZK 80	A-2A	0,75	0,75	-	2770	72	0,80	1,87	2,6	4,8	2,3	-	20	20	9	16	0,00055	8,3
	A-2B	0,62	0,62	0,62	2775	73	0,82	1,49	2,1	5,8	2,8	-	-	-	12	16	0,00055	8,3
	B-2A	1,1	1,1	-	2770	73	0,84	2,58	3,8	4,7	2,3	-	18	12	6	16	0,00066	9,1
	B-2B	0,8	0,8	0,8	2775	74	0,85	1,84	2,	5,9	3,1	-	-	-	9	16	0,00066	9,1
SZK 90	S-2A	1,3	1,3	-	2880	76	0,83	2,97	4,3	6,1	2,4	3,2	20	20	-	16	0,00154	13,4
	S-2B	0,85	0,85	0,85	2905	77	0,83	1,92	2,8	6,6	2,7	3,2	25	25	14	16	0,00154	13,4
	L-2A	1,85	1,85	-	2900	80	0,82	4,07	6,1	7,0	2,8	3,2	13	13	-	16	0,00216	16,4
	L-2B	1,1	1,1	1,1	2915	79	0,82	2,45	3,6	7,2	3,0	3,6	24	24	14	16	0,00216	16,4
2.SZK 100	L-2A	2,5	2,5	-	2860	80	0,83	5,43	8,3	6,5	2,4	2,6	5	5	-	16	0,003	19
	L-2B	1,6	1,6	1,6	2920	80	0,70	4,12	5,2	7,8	3,0	3,1	-	-	5	16	0,003	19
2.SZK 112	M-2A	3,3	3,3	-	2885	84	0,86	6,60	10,9	7,6	3,2	3,3	10	10	-	16	0,005	24
	M-2B	2,2	2,2	2,2	2925	79	0,80	5,03	7,2	8,5	3,5	3,8	-	-	5	16	0,005	24
SZK 132	Sk-2B	4,6	4,6	-	2900	82	0,94	8,6	15,2	7,1	2,0	2,5	10	10	-	16	0,097	55
	Sk-2C	-	-	3,3	2905	82	0,93	6,2	11	7,4	2,2	2,6	19	19	11	16	0,097	55
	S-2A	6,5	-	-	2900	82,5	0,94	12	21,4	7,3	2,1	2,6	9	-	-	16	0,02	61,5
	S-2B	-	5,5	-	2900	82,5	0,94	10,3	18,1	7,4	2,1	2,6	9	9	-	16	0,02	61,5
	S-2C	-	-	4	2905	83	0,93	7,5	13,1	7,5	2,3	2,8	18	18	10	16	0,02	61,5
1.SZK 160	Mk-2A	9,5	-	-	2880	84,5	0,92	17,7	31,5	8,0	2,5	2,3	7	-	-	13	0,021	89
	Mk-2B	-	7,5	-	2900	85	0,92	14,7	24,6	7,4	2,8	2,6	7	7	-	16	0,021	89
	Mk-2C	-	-	5	2910	85	0,93	9,2	16,4	7,7	2,6	2,4	-	-	7	13	0,021	89
	M-2A	13	-	-	2890	85,5	0,92	24	43,0	8,2	2,5	2,5	6	-	-	13	0,028	108,5
	M-2B	-	10	-	2900	85,5	0,93	18,2	32,8	8,0	3,0	2,6	6	6	-	13	0,028	108,5
	M-2C	-	-	6,5	2910	85,5	0,93	11,8	21,2	7,8	2,8	2,6	-	-	6	13	0,028	108,5
	L-2A	16	-	-	2895	87	0,92	29	52,7	8,0	2,5	2,7	7	-	-	13	0,034	113
	L-2B	-	12,5	-	2900	86,5	0,93	22,5	41,1	7,7	3,1	2,6	6	6	-	13	0,034	113
	L-2C	-	-	8	2910	86,5	0,93	14,7	26,1	7,6	2,7	2,5	-	-	6	13	0,034	113
SZK 180	M-2A	19	-	-	2920	88,5	0,92	33,7	62,2	8,0	2,0	2,8	6,5	-	-	10	0,057	138
	M-2B	-	15	-	2930	88	0,92	26,8	48,2	8,5	2,1	3,0	-	6,5	-	10	0,057	138
1.SZK 200	Lk-2A	25	-	-	2935	90	0,87	46	81,4	6,5	1,7	2,5	10	-	-	10	0,11	199,5
	Lk-2B	-	20	-	2945	89,5	0,87	37,1	64,9	8,3	1,7	2,7	-	8	-	10	0,11	199,5
	L-2A	31	-	-	2940	90,5	0,88	56,2	100,7	6,6	1,7	2,5	10	-	-	10	0,13	215
	L-2B	-	24	-	2950	90	0,88	43,7	77,7	8,4	1,6	2,6	-	9	-	10	0,13	215
1.SZK 225	M-2A	38	-	-	2960	92,2	0,89	67	123	7,5	1,8	2,9	11	-	-	10	0,23	290
	M-2B	-	28	-	2960	91,5	0,89	50	90	7,8	1,8	2,9	14	10	-	10	0,23	290
1.SZK 250	M-2A	47	-	-	2965	92,5	0,90	81,5	151	7,5	1,8	2,9	13	-	-	10	0,36	395
	M-2B	-	36	-	2965	92,2	0,90	63	116	7,8	1,8	2,9	17	11	-	10	0,36	395
1.SZK 280	S-2A	64	-	-	2970	93	0,91	109	206	7,8	1,6	2,6	14	-	-	7	0,67	510
	S-2B	-	47	-	2970	92,8	0,91	81	151	8,2	1,7	2,6	17	13	-	7	0,67	510
	M-2A	76	-	-	2970	93,3	0,91	129	244	7,7	1,6	2,5	15	-	-	7	0,81	600
	M-2B	-	58	-	2970	93	0,90	100	187	8,0	1,6	2,5	16	13	-	7	0,81	600
SZK 315	S-2A	95	-	-	2981	93,5	0,92	159	304	7,7	1,4	2,7	16	-	-	7	1,55	810
	S-2B	-	68	-	2983	93,2	0,91	116	218	8,2	1,5	2,7	20	15	-	7	1,55	810
	M-2A	112	-	-	2982	94	0,92	187	359	7,8	1,3	2,7	15	-	-	7	1,8	890
	M-2B	-	80	-	2985	93,6	0,91	136	256	8,4	1,4	2,8	19	15	-	7	1,8	890

Note: Electric motors of frame size 355 and over on a special request !

1500 min<sup>-1</sup>, 400 V, 50 Hz, Insulation class: F, Mechanical protection: IP 55, Temperature class: T1-T4.

Type	Output [kW]			n [min <sup>-1</sup> ]	η [%]	cos φ	I <sub>N</sub> [A]	M <sub>N</sub> [Nm]	I <sub>P</sub> / I <sub>N</sub>	M <sub>P</sub> / M <sub>N</sub>	M <sub>m</sub> / M <sub>N</sub>	t <sub>E</sub> [s]			KR	J [kgm <sup>2</sup> ]	Mass [kg]	
	T1,T2	T3	T4									T1,T2	T3	T4				
1.SZK 71	A-4A	0,25	0,25	0,25	1345	63	0,76	0,75	1,77	3,2	1,7	1,9	60	60	30	13	0,00038	5,3
	A-4B	0,22	0,22	0,22	1370	62	0,74	0,69	1,53	3,3	1,8	2,0	-	-	35	13	0,00038	5,3
	B-4A	0,37	0,37	0,37	1370	66	0,75	1,07	2,58	3,5	2,0	2,1	50	50	20	13	0,00055	6,3
	B-4B	0,32	0,32	0,32	1390	66	0,70	1,00	2,20	3,6	2,1	2,2	-	-	25	13	0,00055	6,3
1.SZK 80	A-4A	0,55	0,55	0,55	1375	69	0,76	1,51	3,80	3,5	1,8	1,9	34,5	31	8	13	0,0009	8,2
	A-4B	0,42	0,42	0,42	1410	73	0,65	1,28	2,84	3,6	1,9	2,0	-	-	10	13	0,0009	8,2
	B-4A	0,75	0,75	-	1375	71	0,75	2,02	5,20	3,7	2,0	2,1	22	22	10	13	0,0011	9,0
	B-4B	0,7	0,7	0,7	1375	72	0,74	1,90	4,86	3,9	2,2	2,3	-	-	12	13	0,0011	9,0
SZK 90	S-4A	1,0	1,0	-	1400	76	0,80	2,38	6,82	5,4	2,2	2,7	24	24	-	13	0,00247	13,2
	S-4B	0,8	0,8	0,8	1400	76	0,82	1,85	5,46	5,3	2,2	2,6	30	30	15	13	0,00247	13,2
	L-4A	1,35	1,35	-	1410	74	0,77	3,42	9,14	5,9	3,0	3,2	18	18	-	16	0,0034	16,9
	L-4B	1,2	1,2	1,2	1420	80	0,81	2,67	8,07	6,6	2,4	3,5	27	27	6	16	0,0034	16,9
2.SZK 100	L-4A	2,0	2,0	-	1410	78	0,78	4,75	13,55	5,9	2,4	2,8	10	10	-	16	0,0054	20,5
	L-4B	1,5	1,5	1,5	1435	78	0,65	4,27	9,88	5,6	2,8	2,9	-	-	5	16	0,0054	20,5
	Ld-4A	2,5	2,5	-	1410	75	0,77	6,27	16,93	6,2	2,7	2,9	10	10	-	16	0,0071	22,6
	Ld-4B	1,7	1,7	1,7	1440	75	0,62	5,28	11,27	6,4	2,7	2,9	-	-	5	16	0,0071	22,6
2.SZK 112	M-4A	3,6	3,6	-	1430	80	0,78	8,33	24,04	6,5	2,9	3,2	5	5	-	16	0,013	28,4
	M-4B	2,4	2,4	2,4	1450	79	0,70	6,26	15,81	5,7	2,3	2,6	-	-	5	16	0,013	28,4
SZK 132	S-4A	5	-	-	1445	86,5	0,84	10,0	33,0	6,0	2,1	2,7	12	-	-	16	0,035	61,5
	S-4B	-	5	-	1445	86,5	0,84	10,0	33,0	6,0	2,1	2,7	12	12	-	16	0,035	61,5
	S-4C	-	-	3,5	1450	86,5	0,83	7	23,0	5,9	2,0	2,6	17	17	8	16	0,035	61,5
	M-4A	6,8	-	-	1445	87,0	0,85	13,3	45,0	6,0	2,2	2,8	14	-	-	16	0,045	73
	M-4B	-	6,8	-	1445	87,0	0,85	13,3	45,0	6,5	2,6	2,8	14	14	-	16	0,045	73
	M-4C	-	-	4,1	1450	87,0	0,84	8,1	27,0	5,9	2,0	2,6	21	21	10	16	0,045	73
1.SZK 160	M-4A	10	-	-	1445	86	0,81	20,5	66,8	7,3	3,2	3,6	8	-	-	16	0,055	89,5
	M-4B	-	10	-	1445	87	0,81	20,5	66,8	7,3	3,2	3,6	8	8	-	16	0,055	89,5
	M-4C	-	-	6,4	1450	87	0,83	12,8	42,6	7,0	3,3	3,7	22	22	6	16	0,055	89,5
	L-4A	13,5	-	-	1445	88	0,83	26,7	90,2	6,5	3,1	3,6	8	-	-	16	0,073	118
	L-4B	-	13,5	-	1445	88	0,83	26,7	90,2	6,5	3,1	3,6	8	8	-	16	0,073	118
	L-4C	-	-	8,5	1450	88	0,84	16,6	56,6	6,0	3,2	3,7	23	23	7	16	0,073	118
1.SZK 180	M-4A	17	-	-	1460	89	0,82	33,6	111	6,2	2,6	2,4	11	-	-	16	0,086	140
	M-4B	-	15	-	1465	89	0,82	29,7	98	7,0	2,9	2,7	-	10	-	16	0,086	140
	L-4A	20	-	-	1460	90	0,82	39,1	131	6,2	2,6	2,4	11	-	-	16	0,102	155
	L-4B	-	17,5	-	1465	90	0,82	34,2	114	7,0	2,9	2,7	-	10	-	16	0,102	155
1.SZK 200	L-4A	27	-	-	1460	90,7	0,88	49,0	175	6,2	2,3	2,3	12	-	-	16	0,27	230
	L-4B	-	24	-	1475	90,7	0,87	44,0	155	7,0	2,6	2,6	14	14	-	16	0,27	230
1.SZK 225	S-4A	33	-	-	1475	92	0,88	59,0	214	7,6	1,8	2,7	11	-	-	13	0,362	280
	S-4B	-	30	-	1480	92	0,87	54	194	8,4	2,0	3,0	-	11,5	-	13	0,362	280
	M-4A	40	-	-	1475	92,4	0,88	71	260	7,5	1,8	2,7	10	-	-	13	0,442	320
	M-4B	-	36	-	1480	92,4	0,87	65	233	8,3	2,0	3,0	-	11	-	13	0,442	320
1.SZK 250	M-4A	50	-	-	1480	92,5	0,89	88	323	6,4	2,2	2,6	7,5	-	-	13	0,64	385
	M-4B	-	44	-	1485	92,8	0,89	77	283	7,3	2,5	3,0	-	8	-	13	0,64	385
1.SZK 280	S-4A	68	-	-	1480	93,4	0,90	117	439	6,4	1,8	2,4	13	-	-	13	1,1	525
	S-4B	-	58	-	1485	93,5	0,88	102	373	7,5	2,0	2,8	-	16	-	13	1,1	525
	M-4A	80	-	-	1480	93,8	0,90	137	516	6,6	1,8	2,5	16	-	-	13	1,31	603
	M-4B	-	70	-	1485	94	0,88	122	450	7,5	2,0	2,8	-	18	-	13	1,31	603
SZK 315	S-4A	100	-	-	1488	94	0,90	188	611	5,8	1,6	2,3	12	-	-	13	3,5	840
	S-4B	-	84	-	1488	94	0,88	155	708	6,7	1,8	2,7	-	14	-	13	3,5	840
	M-4A	120	-	-	1488	94	0,90	220	975	5,8	2,0	2,2	12	-	-	13	3,875	915
	M-4B	-	100	-	1488	94	0,89	180	611	6,7	2,2	2,6	-	14	-	13	3,875	915

Note: Electric motors of frame size 355 and over on a special request !

**1000 min<sup>-1</sup>, 400 V, 50 Hz, Insulation class: F, Mechanical protection: IP 55, Temperature class: T1-T4.**

Type	Output [kW]			n [min <sup>-1</sup> ]	η [%]	cos φ	I <sub>N</sub> [A]	M <sub>N</sub> [Nm]	I <sub>P</sub> / I <sub>N</sub>	M <sub>P</sub> / M <sub>N</sub>	M <sub>m</sub> / M <sub>N</sub>	t <sub>E</sub> [s]			KR	J [kgm <sup>2</sup> ]	Mass [kg]	
	T1,T2	T3	T4									T1,T2	T3	T4				
1.SZK 71	A-6A	0,18	0,18	0,18	900	57	0,65	0,70	1,9	2,6	1,9	2,0	95	80	25	13	0,00055	6,1
	B-6A	0,25	0,25	0,25	890	57	0,64	0,99	2,7	2,6	1,8	2,1	93	77	24	13	0,00071	6,8
1.SZK 80	A-6A	0,37	0,37	0,37	915	66	0,69	1,17	3,9	3,6	2,0	2,2	150	150	54	13	0,0018	9
	B-6A	0,55	0,55	0,55	915	68	0,66	1,77	5,7	3,7	2,4	2,5	74	74	26,5	13	0,0024	11,6
SZK 90	S-6A	0,65	0,65	0,65	935	66	0,69	2,06	6,6	4,7	2,6	3,0	23	23	23	16	0,00247	13
	L-6A	0,95	0,95	0,95	920	67	0,73	2,80	9,9	4,8	2,4	2,8	18	18	6	16	0,0034	16,3
2.SZK 100	L-6A	1,3	1,3	-	930	67	0,70	4,04	13,3	4,2	2,2	2,4	15	15	5	13	0,0054	20,5
	L-6B	1,2	1,2	1,2	940	67	0,66	3,90	12,2	4,4	2,5	2,7	-	-	7	13	0,0054	20,5
2.SZK 112	M-6A	1,9	1,9	-	920	78	0,76	4,63	19,7	4,8	2,5	2,9	10	10	-	16	0,012	27
	M-6B	1,6	1,6	1,6	930	78	0,72	4,11	16,4	5,2	2,9	3,3	-	-	7	16	0,012	27
SZK 132	S-6B	2,6	2,6	-	960	84	0,79	5,7	26	6,0	2,4	2,7	14	-	-	16	0,035	57
	S-6C	-	-	2,2	960	84	0,79	5,7	26	6,0	2,4	2,7	14	14	-	16	0,035	57
	Mk-6B	3,5	3,5	-	950	86	0,80	7,3	36	6,4	2,5	2,8	13	13	-	16	0,0425	68
	Mk-6C	-	-	3,0	950	86	0,80	6,3	30	6,6	2,7	3,1	14	14	6,5	16	0,0425	68
	M-6B	4,8	4,8	-	955	87	0,81	9,9	49	6,4	2,2	2,6	9	9	-	16	0,05	75,5
	M-6C	-	-	4,0	955	86	0,80	8,4	40	6,6	2,2	2,6	11	11	6	16	0,05	75,5
1.SZK 160	M-6B	6,6	6,6	-	950	84	0,78	14,5	66,4	6,5	2,0	2,4	16	16	-	16	0,049	90
	M-6C	-	-	5,0	950	84	0,78	11	66,4	6,7	2,1	2,5	30	21	5,5	16	0,049	90
	L-6B	9,7	9,7	-	950	86	0,78	21	97,5	6,9	2,2	2,5	15	-	-	16	0,070	120
	L-6C	-	-	7,0	950	86	0,78	15,2	97,5	7,3	2,3	2,6	15	8	6	16	0,070	120
1.SZK 180	L-6B	13,2	13,2	-	960	87,5	0,83	26,6	131	6,0	2,2	2,7	15	15	-	16	0,144	150
1.SZK 200	Lk-6B	16,5	16,5	-	970	89	0,83	32,3	163	6,5	2,0	2,7	14	14	-	13	0,225	205
	L-6B	20	20	-	970	90	0,83	39	197	6,5	2,0	2,7	11	11	-	13	0,27	230
1.SZK 225	M-6B	27	27	-	975	91	0,84	51,3	265	6,5	2,0	2,7	19	19	-	13	0,656	330
1.SZK 250	M-6B	33	33	-	980	91	0,85	65	322	6,3	2,0	2,2	16	15	-	13	0,90	390
1.SZK 280	S-6B	40	40	-	985	92,5	0,87	72	388	7,3	2,4	2,7	14	14	-	13	1,5	500
	M-6A	50	-	-	986	92,9	0,88	89	484	7,1	2,3	2,7	-	13	-	13	1,82	560
	M-6B	-	46	-	987	92,8	0,87	82	445	7,7	2,5	2,8	15	-	-	13	1,82	560
1.SZK 315	S-6A	68	-	-	987	92,6	0,86	123	658	7,7	2,4	2,9	19	-	-	13	2,7	730
	S-6B	-	64	-	988	92,7	0,86	116	619	8,2	2,6	3,1	-	13	-	13	2,7	730
	M-6A	82	-	-	986	93	0,88	145	794	7,6	2,3	2,9	18	-	-	13	3,18	840
	M-6B	-	76	-	988	93	0,87	136	735	8,2	2,5	3,1	-	13	-	13	3,18	840

**750 min<sup>-1</sup>, 400 V, 50 Hz, Insulation class: F, Mechanical protection: IP 55, Temperature class: T1-T4.**

Type	Output [kW]			n [min <sup>-1</sup> ]	η [%]	cos φ	I <sub>N</sub> [A]	M <sub>N</sub> [Nm]	I <sub>P</sub> / I <sub>N</sub>	M <sub>P</sub> / M <sub>N</sub>	M <sub>m</sub> / M <sub>N</sub>	t <sub>E</sub> [s]			KR	J [kgm <sup>2</sup> ]	Mass [kg]	
	T1,T2	T3	T4									T1,T2	T3	T4				
1.SZK 71	A-8A	0,09	0,09	0,09	670	43	0,50	0,60	1,28	2,2	1,8	2,0	55	55	22	16	0,00055	6,1
	B-8A	0,12	0,12	0,12	680	46	0,50	0,75	1,68	2,0	1,9	2,2	25	25	13	16	0,00071	6,8
1.SZK 80	A-8A	0,18	0,18	0,18	680	55	0,55	0,86	2,53	2,8	2,2	2,5	30	30	15	16	0,0018	9
	B-8A	0,25	0,25	0,25	690	57	0,56	1,13	3,46	2,8	2,3	2,5	35	35	15	16	0,0024	11,6
SZK 90	S-8A	0,37	0,37	0,37	700	66	0,65	1,24	5,05	3,5	2,0	2,2	55	55	20	16	0,00247	13
	L-8A	0,5	0,5	0,5	700	69	0,67	1,56	6,82	4,0	2,8	2,8	75	75	50	16	0,0034	16,3
2.SZK 100	L-8A	0,65	0,65	0,65	700	64	0,62	2,36	8,87	3,7	2,0	2,4	20	20	10	13	0,0054	20,5
	Ld-8A	0,95	0,95	0,95	680	64	0,65	3,30	13,34	3,5	2,1	2,4	20	20	10	13	0,0071	22,6
2.SZK 112	M-8A	1,3	1,3	1,3	700	71	0,67	3,94	17,74	3,6	2,0	2,2	25	25	10	13	0,012	27
SZK 132	S-8B	1,9	1,9	-	705	78	0,70	5	25,7	4,5	1,6	2,2	16	16	-	13	0,035	54
	M-8AB	2,6	2,6	-	710	79	0,72	6,7	35,0	4,5	1,6	2,3	15	15	-	13	0,050	70,5
1.SZK 160	Mk-8B	3,5	3,5	-	710	78	0,68	9,5	47	4,5	1,9	2,2	14	14	-	13	0,037	87
	M-8B	4,8	4,8	-	710	80	0,68	12,8	64,5	4,6	1,9	2,2	12	12	-	13	0,053	91,5
1.SZK 180	L-8B	6,6	6,6	-	710	82	0,69	16,8	89	4,6	1,9	2,2	11	11	-	13	0,076	122
	L-8B	9,7	9,7	-	715	84	0,74	23	130	5,0	1,9	2,1	11	11	-	13	0,160	160
1.SZK 200	L-8B	13,2	13,2	-	720	87	0,73	30,5	175	5,0	1,8	2,2	10	10	-	13	0,225	205
1.SZK 225	S-8B	16,5	16,5	-	735	88,5	0,78	34,7	214	5,0	1,7	2,2	14	14	-	13	0,470	245
	M-8B	20	20	-	735	89,5	0,78	42	260	5,0	1,7	2,2	15	15	-	13	0,560	285
1.SZK 250	M-8B	27	27	-	735	90	0,80	54	351	5,0	1,6	2,2	10	10	-	13	0,870	370
1.SZK 280	S-8B	33	33	-	740	91,5	0,80	65	426	6,1	1,7	2,2	18	18	-	13	1,5	495
	M-8B	40	40	-	740	92	0,81	78	516	6,2	1,6	2,2	17	17	-	13	1,82	580
1.SZK 315	S-8B	50	50	-	740	92	0,82	96	645	6,5	1,7	2,4	16	16	-	10	2,56	750
	M-8B	68	68	-	740	92,5	0,83	128	877	6,2	1,5	2,3	15	15	-	10	3,32	870

Note: Electric motors of frame size 355 and over on a special request !

2.5 OUTLINE DRAWINGS

Type: **1.SZK**

Protection: **EExe**

Temperature class: **T1 - T4**

**IM B3 - IM 1001**

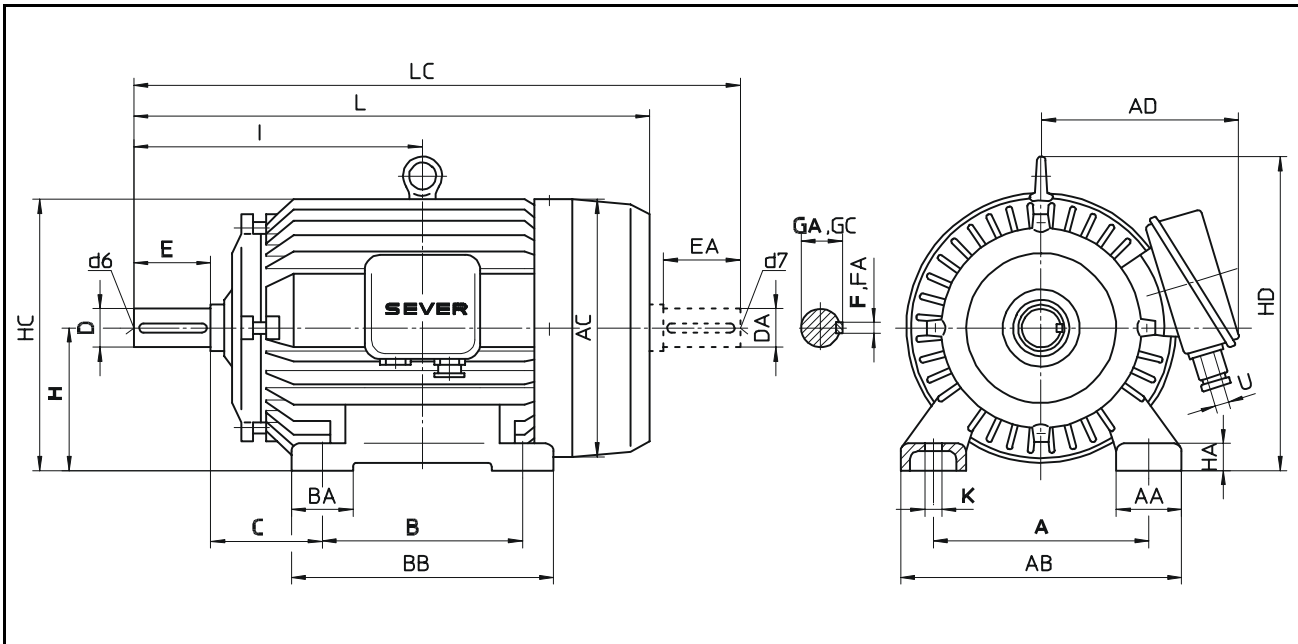

Type	Pole	A	AA	AB	AC	AD	B	BA	BB	C	D	DA	d6	d7	E	EA	F	FA	GA	GC	H	HA	HC	HD	I	K	L	LC	Cable gland	
1.SZK 160	M	2,4,6,8	<b>254</b>	60	314	285	246	<b>210</b>	260	<b>108</b>	<b>42</b>	42	M16	M16	<b>110</b>	110	<b>12</b>	12	<b>45</b>	45	<b>160</b>	23	300,5	345	323	<b>15</b>	589	709	Pg 29x29	
	L	2,4,6,8					<b>254</b>	65	304																345		633	753		
1.SZK 180	M	2,4	<b>279</b>	70	349	323	260	<b>241</b>	296	<b>121</b>	<b>48</b>	48	M16	M16	<b>110</b>	110	<b>14</b>	14	<b>51,5</b>	51,5	<b>180</b>	28	343	387	351,5	<b>15</b>	652	772	Pg 29x29	
	L	4,6,8					<b>279</b>	75	334																370,5		690	810		
1.SZK 200 Lk,L		2,4,6,8	<b>318</b>	80	398	369	289	<b>305</b>	95	375	<b>133</b>	<b>55</b>	55	M20	M20	<b>110</b>	110	<b>16</b>	16	<b>59</b>	59	<b>200</b>	30	387,5	440	395,5	<b>19</b>	756	876	Pg 36x37
1.SZK 225	S	4,8						<b>286</b>	355		<b>60</b>	60			<b>140</b>	140	<b>18</b>	18	<b>64</b>	64					432		805	960	Pg 36x37	
	M	2	<b>356</b>	90	446	418	337		110	<b>149</b>	<b>55</b>	55	M20	M20	<b>110</b>	110	<b>16</b>	16	<b>59</b>	59	<b>225</b>	35	438	500	414,5	<b>19</b>	800	925		
		4,6,8						<b>311</b>	380		<b>60</b>	60			<b>140</b>	140	<b>18</b>	18	<b>64</b>	64					444,5		830	985		
1.SZK 250	S	2	<b>406</b>	100	508	474	360	<b>349</b>	95	430	<b>168</b>	<b>60</b>	60	M20	M20	<b>140</b>	140	<b>18</b>	18	<b>64</b>	64	<b>250</b>	40	487,5	549	482,5	<b>24</b>	906	1061	Pg 36x37
	M	4,6,8									<b>65</b>	65						<b>69</b>	69											
1.SZK 280	S	2						<b>368</b>	450		<b>65</b>	65						<b>18</b>	18	<b>69</b>	69				514		973	1128	Pg 36x37	
		4,6,8								<b>75</b>	75							<b>20</b>	20	<b>79,5</b>	79,5									
	M	2	<b>457</b>	110	567	510	379		112	<b>190</b>	<b>65</b>	65	M20	M20	<b>140</b>	140		<b>18</b>	18	<b>69</b>	69	<b>280</b>	45	535	607	539		1024		1179
4,6,8							<b>419</b>	500			<b>75</b>	75						<b>20</b>	20	<b>79,5</b>	79,5									
1.SZK 315	S	6,8	<b>508</b>	125	633	562	427	<b>406</b>	500		<b>216</b>	<b>80</b>	80	M20	M20	<b>170</b>	170	<b>22</b>	22	<b>85</b>	85	<b>315</b>	50	598,5	669	589	<b>28</b>	1102	1277	Pg 42x42
	M	6,8						<b>457</b>	550																614,5		1153	1328		

Mounting dimensions given in bold figures are obligatory in the sense of IEC recommendations.

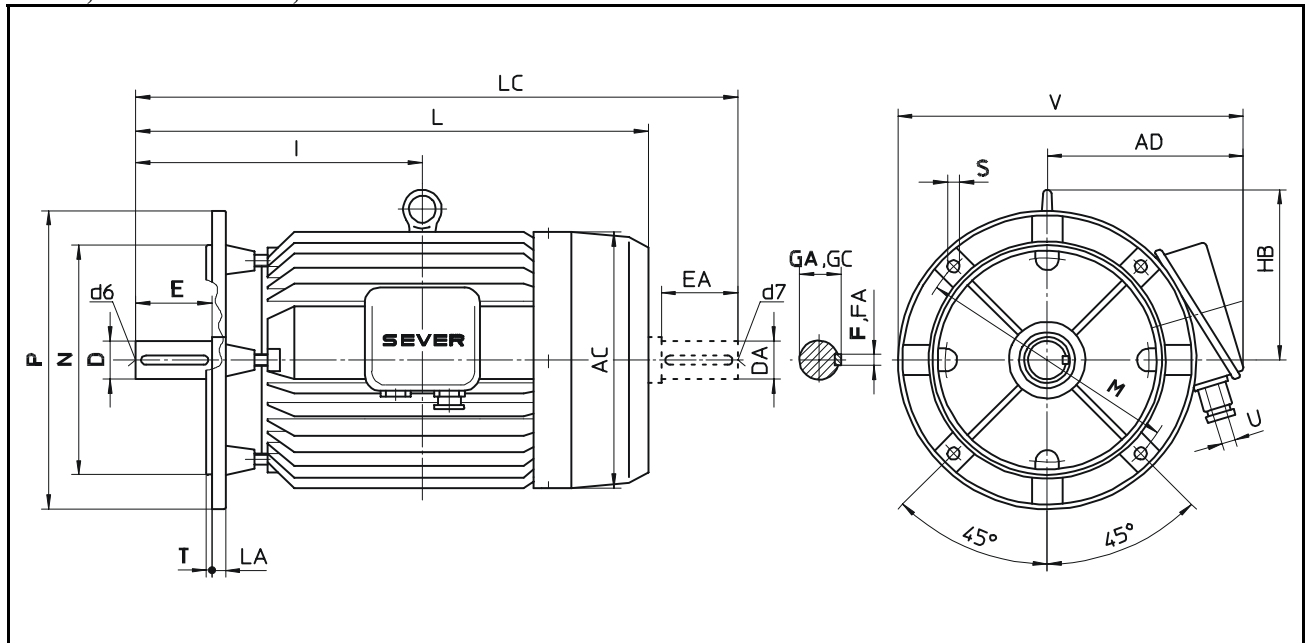

Type: **1.SZK**Protection: **EExe**Temperature class: **T1 - T4****IM B5, IM V1 - IM 3001, IM 3011**

Type	Pole	Flange	AC	AD	D	DA	d6	d7	E	EA	F	FA	GA	GC	HB	I	L	LA	LC	M	N	P	S	Num. of holes	T	V	Cable gland										
1.SZK 160	Mk	2,4,6,8	FF 300	285	246	42	42	M16	M16	110	110	12	12	45	45	185	323	589	20	709	300	250	350	19	4	4	421	Pg 29x29									
	M	2,4,6,8																																			
	L	2,4,6,8																																			
1.SZK 180	M	2,4	FF 300	325	260	48	48	M16	M16	110	110	14	14	51,5	51,5	207	351,5	652	20	772	300	250	350	19	4	5	435	Pg 29x29									
	L	2,4,6																																			
1.SZK 200 Lk,L		2,4,6,8	FF 350	369	299	55	55	M20	M20	110	110	16	16	59	59	240	395,5	756	20	876	350	300	400	19	4	5	499	Pg 36x37									
1.SZK 225	S	4,6,8	FF 400	418	337	60	60	M20	M20	110	110	16	16	59	59	275	432	805	20	960	400	350	450	18	8	5	537	Pg 36x37									
	M	2				55	55																						140	140	18	18	64	64	444,5	830	985
	M	4,6,8				60	60																						140	140	18	18	64	64	444,5	830	985
1.SZK 250	M	2	FF 500	471	360	60	60	M20	M20	140	140	18	18	64	64	299	482,5	906	22	1061	500	450	550	19	8	5	635	Pg 36x37									
	M	4,6,8				65	65																						140	140	18	18	69	69	539,5	1024	1179
1.SZK 280	S	2	FF 500	510	379	65	65	M20	M20	140	140	18	18	69	69	327	514	973	22	1128	500	450	550	19	8	5	654	Pg 36x37									
	S	4,6,8				75	75																						140	140	18	18	79,5	79,5	539,5	1024	1179
	M	2				65	65																						140	140	18	18	69	69	539,5	1024	1179
	M	4,6,8				75	75																						140	140	18	18	79,5	79,5	539,5	1024	1179
1.SZK 315	S	6,8	FF 600	562	427	80	80	M20	M20	170	170	22	22	85	85	344,5	589	1102	25	1277	600	550	660	24	8	6	757	Pg 42x42									
	M	6,8															614,5	1153		1328																	

Mounting dimensions given in bold figures are obligatory in the sense of IEC recommendations.

Type: **.SZK**  
 Protection: **EExe**  
 Temperature class: **T1 - T4**

**IM B3 - IM 1001**

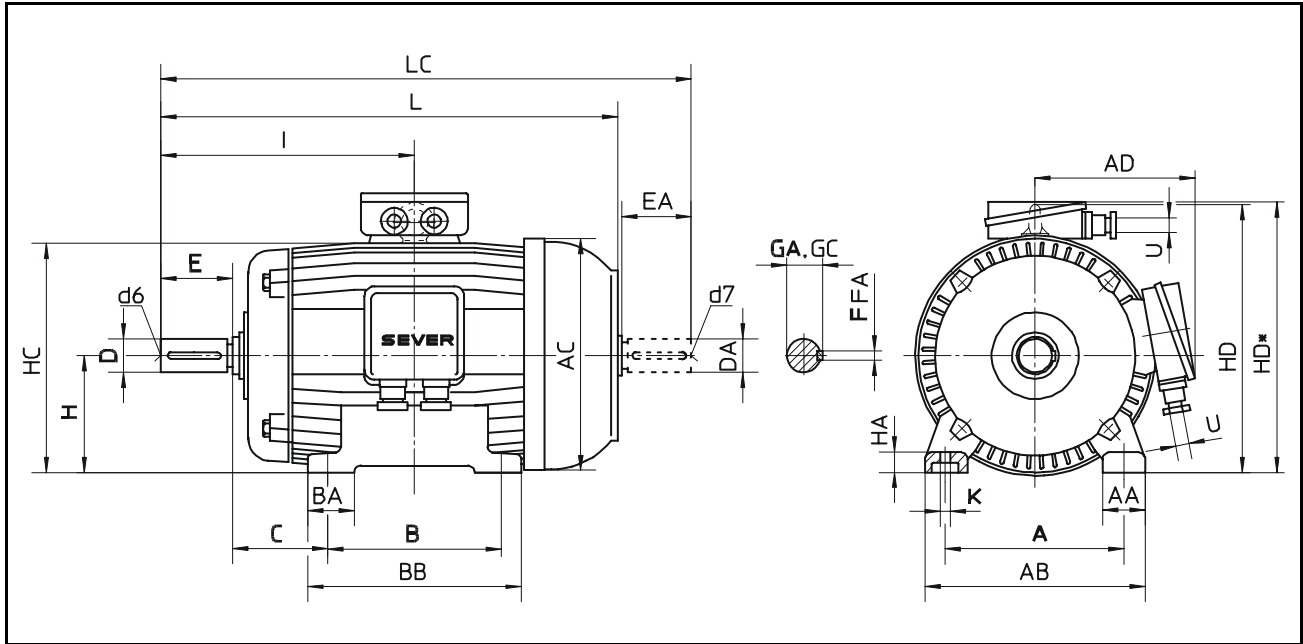

Type	Pole	A	AA	AB	AC	AD	B	BA	BB	C	D	DA	d6	d7	E	EA	F	FA	GA	GC	H	HA	HC	HD	HD*	I	K	L	LC	Cable gland			
<b>1.SZK 71</b>	2,4,6,8	<b>112</b>	35	142	139	-	<b>90</b>	33	114	<b>45</b>	<b>14</b>	11	M5	M5	<b>30</b>	23	<b>5</b>	<b>4</b>	<b>16</b>	12,5	<b>71</b>	10	139	-	191	120	<b>7</b>	241	267	Pg 13,5x13			
<b>1.SZK 80</b>	2,4,6,8	<b>125</b>	41	155	157	-	<b>100</b>	40	130	<b>50</b>	<b>19</b>	14	M6	M6	<b>40</b>	30	<b>6</b>	<b>5</b>	<b>21,5</b>	16	<b>80</b>	11	156	-	210	140	<b>10</b>	271	304	Pg 13,5x13			
<b>SZK 90</b>	<b>S</b>	2,4,6,8	<b>140</b>	40	180	178	-	<b>100</b>	40	130	<b>56</b>	<b>24</b>	24	M8	M8	<b>50</b>	50	<b>8</b>	<b>8</b>	<b>27</b>	27	<b>90</b>	15	178	-	250	156	<b>10</b>	300	356	Pg 13,5x13		
	<b>L</b>	2,4,6,8	<b>140</b>	40	180	178	-	<b>125</b>	40	155	<b>56</b>	<b>24</b>	24	M8	M8	<b>50</b>	50	<b>8</b>	<b>8</b>	<b>27</b>	27	<b>90</b>	15	178	-	250	168,5	<b>10</b>	325	381			
<b>2.SZK 100</b>	<b>L</b>	2,4,6,8	<b>160</b>	44	204	198	-	<b>140</b>	48	175	<b>63</b>	<b>28</b>	28	M10	M10	<b>60</b>	60	<b>8</b>	<b>8</b>	<b>31</b>	31	<b>100</b>	16	198	-	274	193	<b>12</b>	370	438	Pg 13,5x13		
	<b>Ld</b>	4,8	<b>160</b>	44	204	198	-	<b>140</b>	48	175	<b>63</b>	<b>28</b>	28	M10	M10	<b>60</b>	60	<b>8</b>	<b>8</b>	<b>31</b>	31	<b>100</b>	16	198	-	274	193	<b>12</b>	370	438			
<b>2.SZK 112 M</b>	2,4,6,8	<b>190</b>	46	236	222	-	<b>140</b>	48	175	<b>70</b>	<b>28</b>	28	M10	M10	<b>60</b>	60	<b>8</b>	<b>8</b>	<b>31</b>	31	<b>112</b>	20	222	-	311	200	<b>12</b>	377	445	Pg 21x20			
<b>SZK132</b>	<b>Sk</b>	2					<b>140</b>		180																		239	<b>12</b>	441	529	Pg 21x20		
	<b>S</b>	2,4,6,8	<b>216</b>	55	271	260	214		52		<b>89</b>	<b>38</b>	38	M12	M12	<b>80</b>	80	<b>10</b>	10	<b>41</b>	41	<b>132</b>	22	261	307	-	258						
	<b>M k</b>	6					<b>178</b>		218																				479	567			
	<b>M</b>	2,4,6,8																															
<b>SZK 315</b>	<b>S</b>	2					<b>406</b>	150	500		<b>65</b>	65			<b>140</b>	140	<b>18</b>	18	<b>69</b>	69						615	705	-	559	<b>28</b>	1072	1232	Pg 42x42
		4	<b>508</b>	125	633					<b>216</b>	<b>80</b>	80			<b>170</b>	170	<b>22</b>	22	<b>85</b>	85					615	705	-	589		1102	1292		
		2									<b>65</b>	65			<b>140</b>	140	<b>18</b>	18	<b>69</b>	69					615	705	-	584,5		1123	1283		
	<b>M</b>	4					<b>457</b>	150	550		<b>80</b>	80			<b>170</b>	170	<b>22</b>	22	<b>85</b>	85					615	705	-	614,5		1153	1343		

**Note:** for frame size from 71 up to 112 terminal box is on the top,  
 for frame size from 132 up to 315 terminal box is on the right-hand side.

Type: **.SZK**  
 Protection: **EExe**  
 Temperature class: **T1 - T4**

**IM B5, IM V1 - IM 3001, IM 3011**

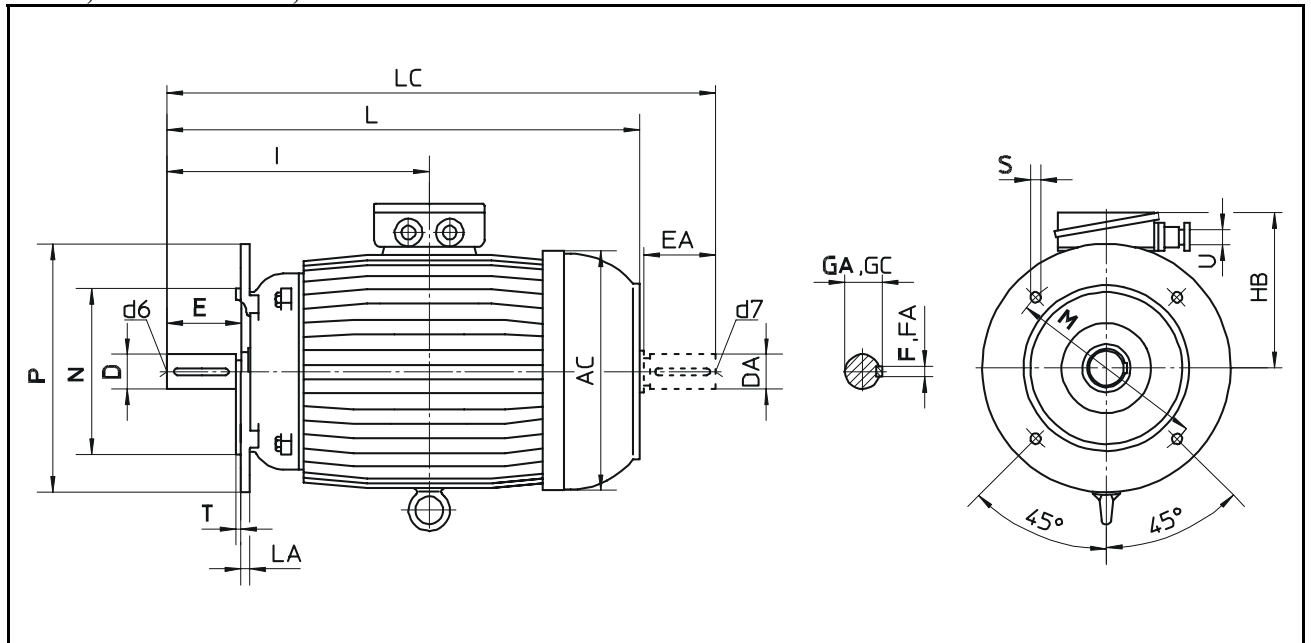

Type	Pole	Flange	AC	AD	D	DA	d6	d7	E	EA	F	FA	GA	GC	HB	I	L	LA	LC	M	N	P	S	Num. of holes	T	V	Cable gland										
<b>1.SZK 71</b>	2,4,6,8	FF130	139	120	<b>14</b>	11	M5	M5	<b>30</b>	23	<b>5</b>	4	16	12,5	120	120	241	10	267	<b>130</b>	<b>110</b>	<b>160</b>	<b>10</b>	4	<b>3,5</b>	200	Pg 13,5x13										
<b>1.SZK 80</b>	2,4,6,8	FF165	157	130	<b>19</b>	14	M6	M6	<b>40</b>	30	<b>6</b>	5	21,5	16	130	140	271	12	304	<b>165</b>	<b>130</b>	<b>200</b>	<b>12</b>	4	<b>3,5</b>	230	Pg 13,5x13										
<b>SZK 90</b>	S	2,4,6,8	FF165	178	160	<b>24</b>	24	M8	M8	<b>50</b>	50	<b>8</b>	8	27	27	160	156	300	12	356	<b>165</b>	<b>130</b>	<b>200</b>	<b>12</b>	4	<b>3,5</b>	260	Pg 13,5x13									
	L	2,4,6,8															168,5	325		381																	
<b>2.SZK 100</b>	L	2,4,6,8	FF215	198	174	<b>28</b>	28	M10	M10	<b>60</b>	60	<b>8</b>	8	31	31	174	193	370	16	438	<b>215</b>	<b>180</b>	<b>250</b>	<b>15</b>	4	<b>4</b>	299	Pg 13,5x13									
	Ld	2,4,6																																			
<b>2.SZK 112 M</b>	2,4,6,8	FF215	222	199	<b>28</b>	28	M10	M10	<b>60</b>	60	<b>8</b>	8	31	31	199	200	377	16	445	<b>215</b>	<b>180</b>	<b>250</b>	<b>15</b>	4	<b>4</b>	324	Pg 21x20										
<b>SZK 132</b>	Sk	2	FF265	260	214	<b>38</b>	38	M12	M12	<b>80</b>	80	<b>10</b>	10	41	41	175	239	441	20	529	<b>265</b>	<b>230</b>	<b>300</b>	<b>15</b>	4	<b>4</b>	364	Pg 21x20									
	S	4,6,8															258	479		567																	
	Mk	2																																			
	M	4,6,8																																			
<b>SZK 315</b>	S	2	FF600	598	447	<b>65</b>	65	M20	M20	<b>140</b>	140	<b>18</b>	18	69	69	390	559	1072	25	1232	<b>600</b>	<b>550</b>	<b>660</b>	<b>24</b>	8	<b>6</b>	747	Pg 42x42									
	—	4															<b>80</b>	80		<b>170</b>									170	<b>22</b>	22	85	85	390	589	1102	1292
		2															<b>65</b>	65		<b>140</b>									140	<b>18</b>	18	69	69	390	584,5	1123	1283
	M	4															598	447		<b>80</b>									80	<b>170</b>	170	<b>22</b>	22	85	85	390	614,5

Mounting dimensions given in bold figures are obligatory in the sense of IEC recommendations.

Type: .SZK

Protection: EExe

Temperature class: T1 - T4

## IM B14 - IM 3601

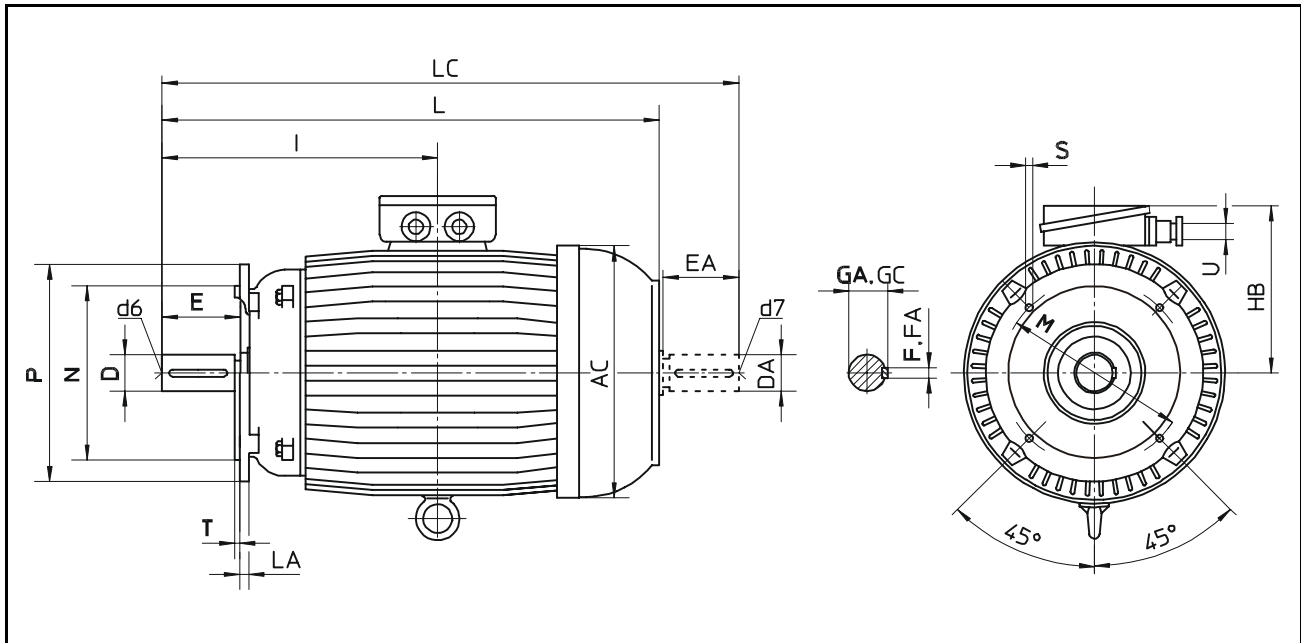

Type	Pole	Flange	AC	AD	D	DA	d6	d7	E	EA	F	FA	GA	GC	HB	I	L	LA	LC	M	N	P	S	T	Cable gland
1.SZK 71	2,4,6,8	F 85	139	120	<b>14</b>	11	M5	M5	<b>30</b>	23	<b>5</b>	4	16	12,5	120	120	241	8	267	<b>85</b>	<b>70</b>	<b>105</b>	<b>M6</b>	<b>2,5</b>	Pg 13,5x13
	2,4,6,8	F 115																10		<b>115</b>	<b>95</b>	<b>140</b>	<b>M8</b>	<b>3</b>	
1.SZK 80	2,4,6,8	F 100	157	130	<b>19</b>	14	M6	M6	<b>40</b>	30	<b>6</b>	5	21,5	16	130	140	271	8	304	<b>100</b>	<b>80</b>	<b>120</b>	<b>M6</b>	<b>3</b>	Pg 13,5x13
		F 130																10		<b>130</b>	<b>110</b>	<b>160</b>	<b>M8</b>	<b>3,5</b>	
SZK 90	S	2,4,6,8	F 115													156	300		356	<b>115</b>	<b>95</b>	<b>140</b>		<b>3</b>	Pg 13,5x13
		2,4,6,8	F 130	178	169	<b>24</b>	24	M8	M8	<b>50</b>	50	<b>8</b>	8	27	27	160		10		<b>130</b>	<b>110</b>	<b>160</b>	<b>M8</b>	<b>3,5</b>	
L	2,4,6,8	F 115														168,5	325		381	<b>115</b>	<b>95</b>	<b>140</b>		<b>3</b>	Pg 13,5x13
	2,4,6,8	F 130																		<b>130</b>	<b>110</b>	<b>160</b>		<b>3,5</b>	
2.SZK 100	L	2,4,6,8	F 130															10		<b>130</b>	<b>110</b>	<b>160</b>	<b>M8</b>		Pg 13,5x13
		2,4,6	F 165	198	174	<b>28</b>	28	M10	M10	<b>60</b>	60	<b>8</b>	8	31	31	174	193	370	12	438	<b>165</b>	<b>130</b>	<b>200</b>	<b>M10</b>	
Ld	2,4,6,8	F 130																10		<b>130</b>	<b>110</b>	<b>160</b>	<b>M8</b>		Pg 13,5x13
	2,4,6	F 165																12		<b>165</b>	<b>130</b>	<b>200</b>	<b>M10</b>	<b>3,5</b>	
2.SZK 112	2,4,6,8	F 130	222	199	<b>28</b>	28	M10	M10	<b>60</b>	60	<b>8</b>	8	31	31	199	200	377	10	445	<b>130</b>	<b>110</b>	<b>160</b>	<b>M8</b>	<b>3,5</b>	Pg 21x20
		F 165																12		<b>165</b>	<b>130</b>	<b>200</b>	<b>M10</b>	<b>3,5</b>	

Mounting dimensions given in bold figures are obligatory in the sense of IEC recommendations.

## 2.6 PARTS

PARTS OF ELECTRIC MOTORS

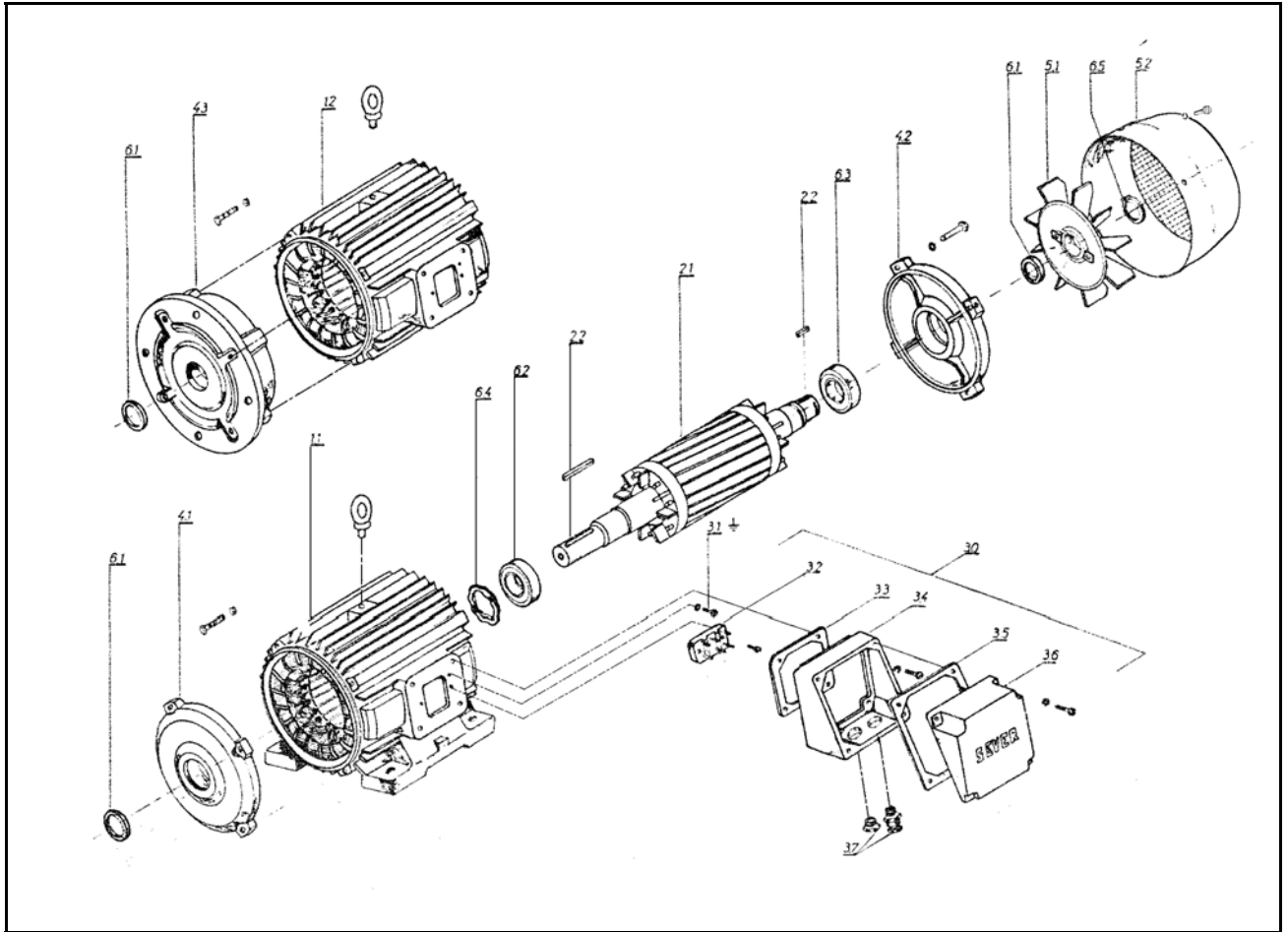
MOTOR TYPE: **SKZ 132-160**

ITEM	DESCRIPTION
1.1	STATOR - SET IM B3
1.2	STATOR - SET IM B5
2.1	ROTOR - SET
2.2	ROTOR KEY
3.0	TERMINAL BOX - SET
3.1	EARTH TERMINAL
3.2	TERMINAL BOARD WITH ACCESSORIES (EExe)
3.3	GASKET FOR TERMINAL BOX FRAME
3.4	TERMINAL BOX FRAME
3.5	GASKET FOR TERMINAL BOX COVER
3.6	TERMINAL BOX COVER
3.7	CABLE GLAND
4.1	STATOR COVER - DRIVE SIDE (A)
4.2	STATOR COVER - FAN SIDE (B)
4.3	FLANGE
5.1	FAN
5.2	FAN COVER
6.1	RADIAL SHAFT SEAL
6.2	BEARING - DRIVE SIDE (A)
6.3	BEARING - FAN SIDE (B)
6.4	RESILIENT PRELOADING RING
6.5	CIRCLIP
6.6	BEARING COVER, EXTERNAL - DRIVE SIDE (A)
6.7	BEARING COVER, EXTERNAL - FAN SIDE (B)

## PARTS OF ELECTRIC MOTORS

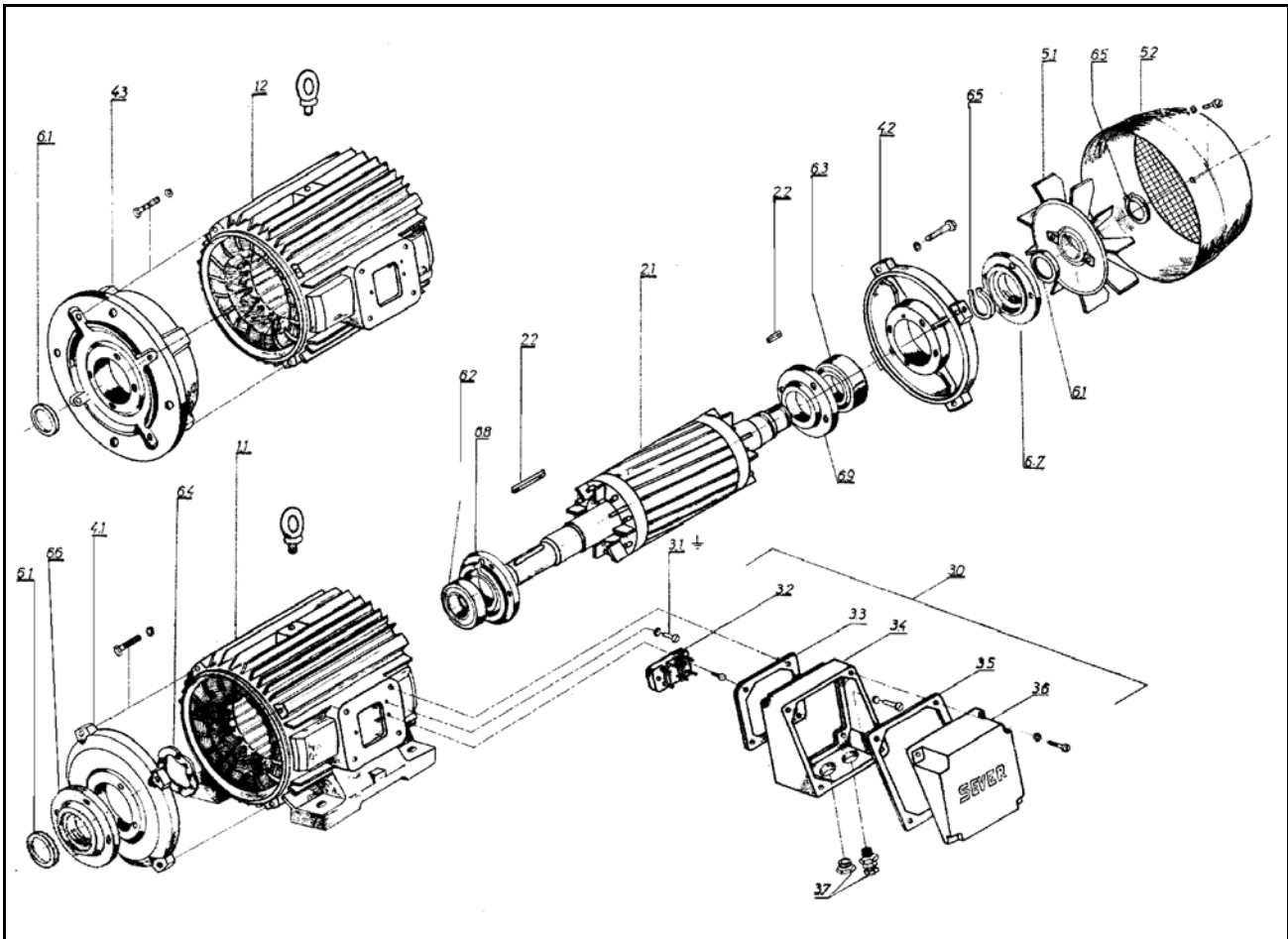
MOTOR TYPE: **1.SZK 180-225**  
**ZK 180-200**

ITEM	DESCRIPTION
1.1	STATOR - SET IM B3
1.2	STATOR - SET IM B5
2.1	ROTOR - SET
2.2	ROTOR KEY
3.0	TERMINAL BOX - SET
3.1	EARTH TERMINAL
3.2	TERMINAL BOARD WITH ACCESSORIES (EExe)
3.3	GASKET FOR TERMINAL BOX FRAME
3.4	TERMINAL BOX FRAME
3.5	GASKET FOR TERMINAL BOX COVER
3.6	TERMINAL BOX COVER
3.7	CABLE GLAND
4.1	STATOR COVER - DRIVE SIDE (A)
4.2	STATOR COVER - FAN SIDE (B)
4.3	FLANGE
5.1	FAN
5.2	FAN COVER
6.1	RADIAL SHAFT SEAL
6.2	BEARING - DRIVE SIDE (A)
6.3	BEARING - FAN SIDE (B)
6.4	RESILIENT PRELOADING RING
6.5	CIRCLIP
6.6	BEARING COVER, EXTERNAL - DRIVE SIDE (A)
6.7	BEARING COVER, EXTERNAL - FAN SIDE (B)
6.8	BEARING COVER, INTERNAL - DRIVE SIDE (A)
6.9	BEARING COVER, INTERNAL - FAN SIDE (A)

## PARTS OF ELECTRIC MOTORS

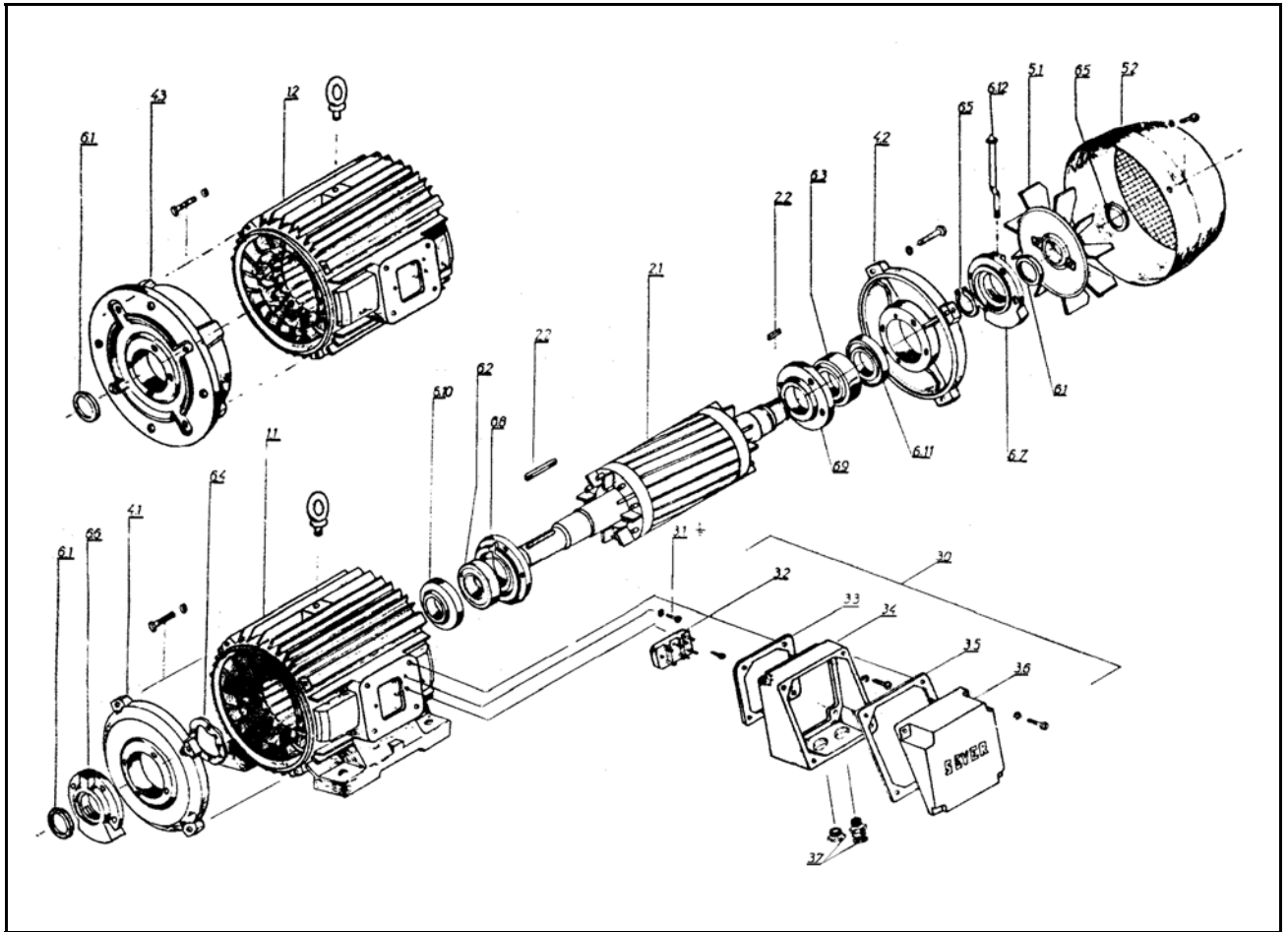
MOTOR TYPE: **1.SZK 250-315**

ITEM	DESCRIPTION
1.1	STATOR - SET IM B3
1.2	STATOR - SET IM B5
2.1	ROTOR - SET
2.2	ROTOR KEY
3.0	TERMINAL BOX - SET
3.1	EARTH TERMINAL
3.2	TERMINAL BOARD WITH ACCESSORIES (EExe)
3.3	GASKET FOR TERMINAL BOX FRAME
3.4	TERMINAL BOX FRAME
3.5	GASKET FOR TERMINAL BOX COVER
3.6	TERMINAL BOX COVER
3.7	CABLE GLAND
4.1	STATOR COVER - DRIVE SIDE (A)
4.2	STATOR COVER - FAN SIDE (B)
4.3	FLANGE
5.1	FAN
5.2	FAN COVER
6.1	RADIAL SHAFT SEAL
6.2	BEARING - DRIVE SIDE (A)
6.3	BEARING - FAN SIDE (B)
6.4	RESILIENT PRELOADING RING
6.5	CIRCLIP
6.6	BEARING COVER, EXTERNAL - DRIVE SIDE (A)
6.7	BEARING COVER, EXTERNAL - FAN SIDE (B)
6.8	BEARING COVER, INTERNAL - DRIVE SIDE (A)
6.9	BEARING COVER, INTERNAL - FAN SIDE (B)
6.10	GREASE QUANTITY REGULATOR - DRIVE SIDE (A)
6.11	GREASE QUANTITY REGULATOR - FAN SIDE (B)
6.12	RE-GREASING DEVICE

### 3. MOTORS IN PROTECTION OF FLAMEPROOF ENCLOSURE EExd

#### 3.1 EXPLOSION-PROOF PROTECTION FLAMEPROOF ENCLOSURE EExd

The basic conception of the explosion proof protection flameproof enclosure EExd is that the parts of the electric device, which may cause ignition of explosive mixture, must be enclosed in an enclosure, which is the basic support of protection.

The enclosures are made of in a way so that:

- ◆ they can endure inner pressure of explosion without damage or not allowed deformation,
- ◆ they prevent penetrating ignition through the safety gaps in the external atmosphere.

**I** for application in mines,

**II** for application in surface industry.

Enclosures of group **II** are divided into subgroups **IIA**, **IIB** and **IIC** taking into consideration the classification of gases and vapours according to explosive groups. Classification of gases and vapours according to maximum experimental safety gap is given in the following table.

Equipment group	Group of gasses	Max. safety gap [mm] measured at length of 25 mm
II	A	gap $\geq$ 0.9
	B	$0.5 < \text{gap} < 0.9$
	C	gap $< 0.5$

Safety gap is provided by machining surface of the assembly parts with min. roughness of 3.2  $\mu\text{m}$ . Machining traces can be seen, but can not be perceived by fingers. According to the type, safety gaps are classified as flat, cylindrical, screw and labyrinth ones. During testing, a flameproof enclosure must satisfy the following:

- a) test control by increased pressure
- b) test control by penetrating ignition.

Test control by increased pressure is performed with the aim to establish the referent pressure of explosion, and it is made by explosion of the test mixture for the appropriate group of gases. This treatment must not cause permanent deformation or damage of the device enclosure.

Test control by penetrating ignition is performed on the following way: the apparatus enclosure is filled with explosive mixture, then, this mixture is ignited inside the device. In a number of conducted tests it is registered if ignition of surrounding test mixture occurs through the gaps of the tested apparatus. Assembly screws for flameproof enclosures must be secure of loosening by using their special designs and also by using suitable flexible safety washers. In addition, current connections can be tested by indirect entry through the terminal box in a flameproof enclosure EExd or in increased safety EExe.

Electric leads from the terminal box, towards the interior of the flameproof enclosure can be led only through flameproof bushings molded in the insulation mass.

The limit temperature and the temperature rise of the enclosure in the external atmosphere must not exceed the values of the corresponding temperature class.



## 3.2 DESIGN

### 3.2.1 Forms, mechanical protection, constructional characteristics and materials of electric motor EExd

Explosion-proof protection flameproof enclosure EExd is realized by cylindrical and flat gaps, which meet the requirements of the standard IEC 60079-1/EN 50018/DIN EN50018/VDE 0171-5.

Motors, type St 1.ZK.. are three phase induction squirrel cage electric motors, single or multi-speed, for mounting arrangements IMB3, IMB5, IMV3, IMV5 and IMV6 (IEC 60034-7, DIN 42950 04,64).Cooling system is IC 411 as per IEC 60034-6 and degree of mechanical protection is IP 54 as per IEC 60034-5, DIN IEC 60034-5/VDE 0530-5.The motors are designed for the following application fields:

- a) mines, i.e. pit mining **EExd I**
- b) surface industry **EExd II** for:
  - group of gases **A, B, C** and
  - temperature classes **T1-T4**

Electric motors are made with the insulation class **F**.

Materials for electric motors EExd

Frame size	Electric motor parts								
	Stator frame	Feet	Stator cover	Fan cover		Fan for both way rotation		Terminal box	
				Exd I	Exd II	Exd I	Exd II	Exd I	Exd II
71	cast iron	cast iron	cast iron	steel	steel	cast iron	aluminium alloy	cast iron	aluminium alloy
80									
90									
100									
112									
132									
160									
180	steel	welded							
200									
225									
250									
280									
315				steel					

### 3.2.2 Terminal box and assembly drawings

Terminal box is designed in two versions:

- a) Terminal box in increased safety EExe (fig.2) is made of aluminium alloy and it is with an interplate, where the outlet leads are molded in, and with a certified terminal board. Cable entries of a terminal box in explosion-proof protection EExe and EExd II are type Pg (DIN 46255).
- b) Cast iron terminal box (fig.3) has two chambers, one of which is in protection EExd and the other one is in protection EExe. Chambers are connected by three flameproof bushings. A certified cable gland with trumpet is fitted to the terminal box and this design is used with electric motors both for mines and for surface industry. This terminal box has three connections (flameproof bushings) and it is used only for motors with direct starting. On a special request, for electric motors in EExd I (for mines), the terminal box and the cable gland with trumpet can be protected with an additional shield, which protects the terminal box and the cable gland against mechanical damages.

Table for fig. 2.

Frame size	a	b	c	d	e	h	Cable gland as per DIN 46255 *	Terminal board **
71 and 80	90	36	-	14	66	62	Pg-13,5	KB1 Ex
90 and 100	104	36	-	14	73	84	Pg-13,5	KB1 Ex
112 and 132	128	42	-	21	92	94	Pg-21	KB2 Ex
160 and 180	148	55	-	30	105	105	Pg-29	KB3 Ex
200 and 225	170	70	-	38	120	110,5	Pg 36	KB4 Ex
250 and 280	200	70	-	38	135	128	Pg 36	KB4 Ex
315	250	80	-	43	165	142	Pg 42	KB5 Ex

Table for fig. 3.

Frame size	a	b	c	d	e	h	Cable gland with trumpet as per EN 50014 and EN 50018 *	Type of flameproof bushing **
71 and 80	160	115	98	15	172	105	Re-13,5	PI 16
90 and 100	176	126	110	15	188	113		
112	200	138	126	19	208	115	Re-16	PI 25
132							Re-21	
160 and 180	230	156	150	24	256	117	Re-29	PI 63
200 and 225	276	176	181	34	313	135	Re 36	PI 100
250 and 280	377	226	247	34	380	186	Re 36	PI 160
315	422	270	283	41	330	197	Re 42	PI 250

All dimensions in millimeters.

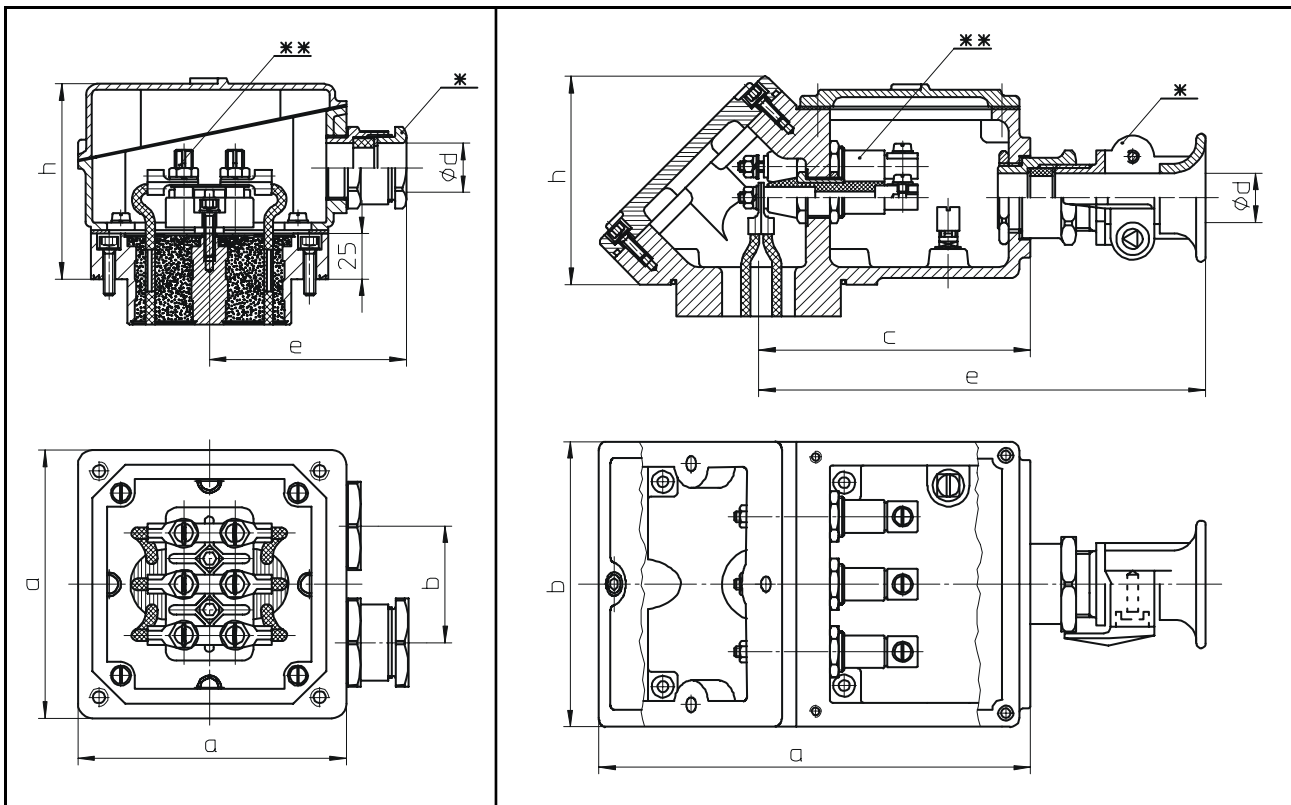
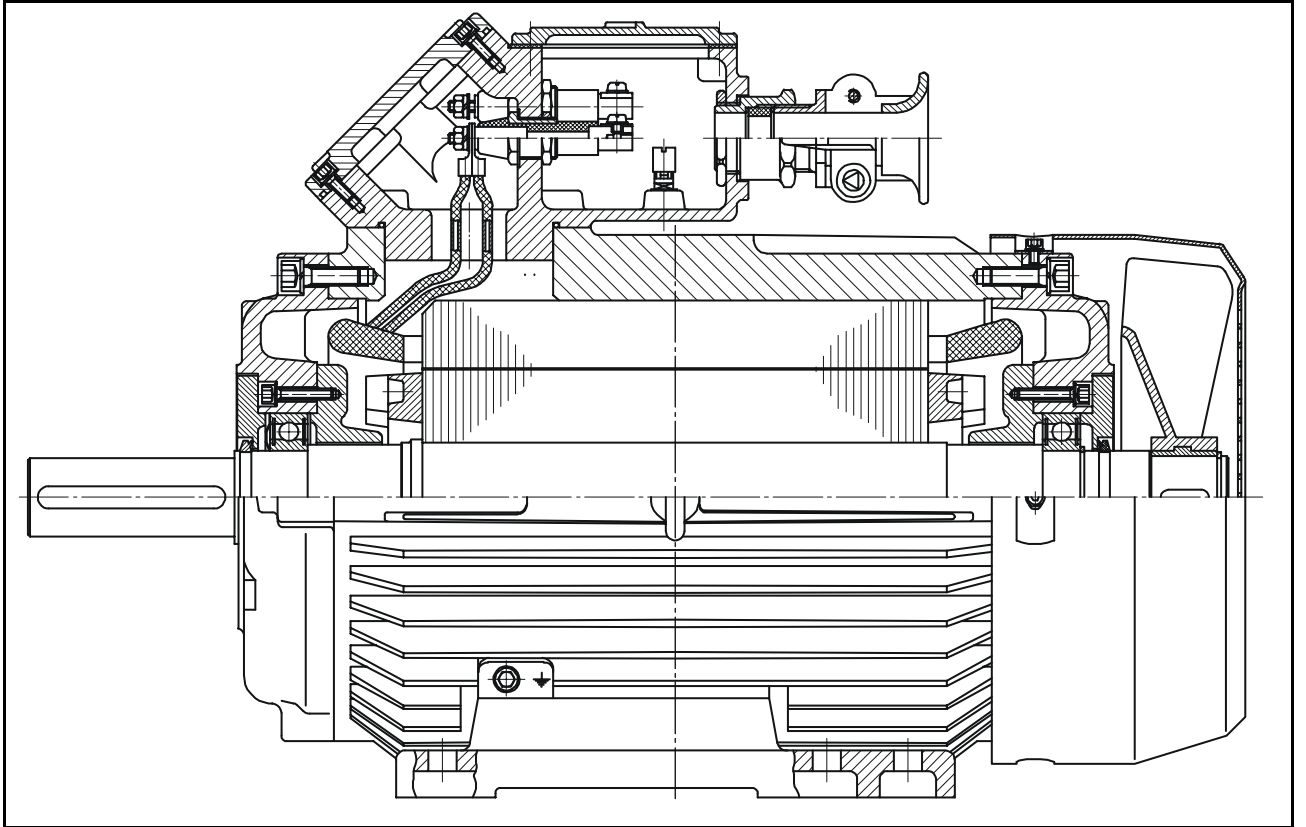
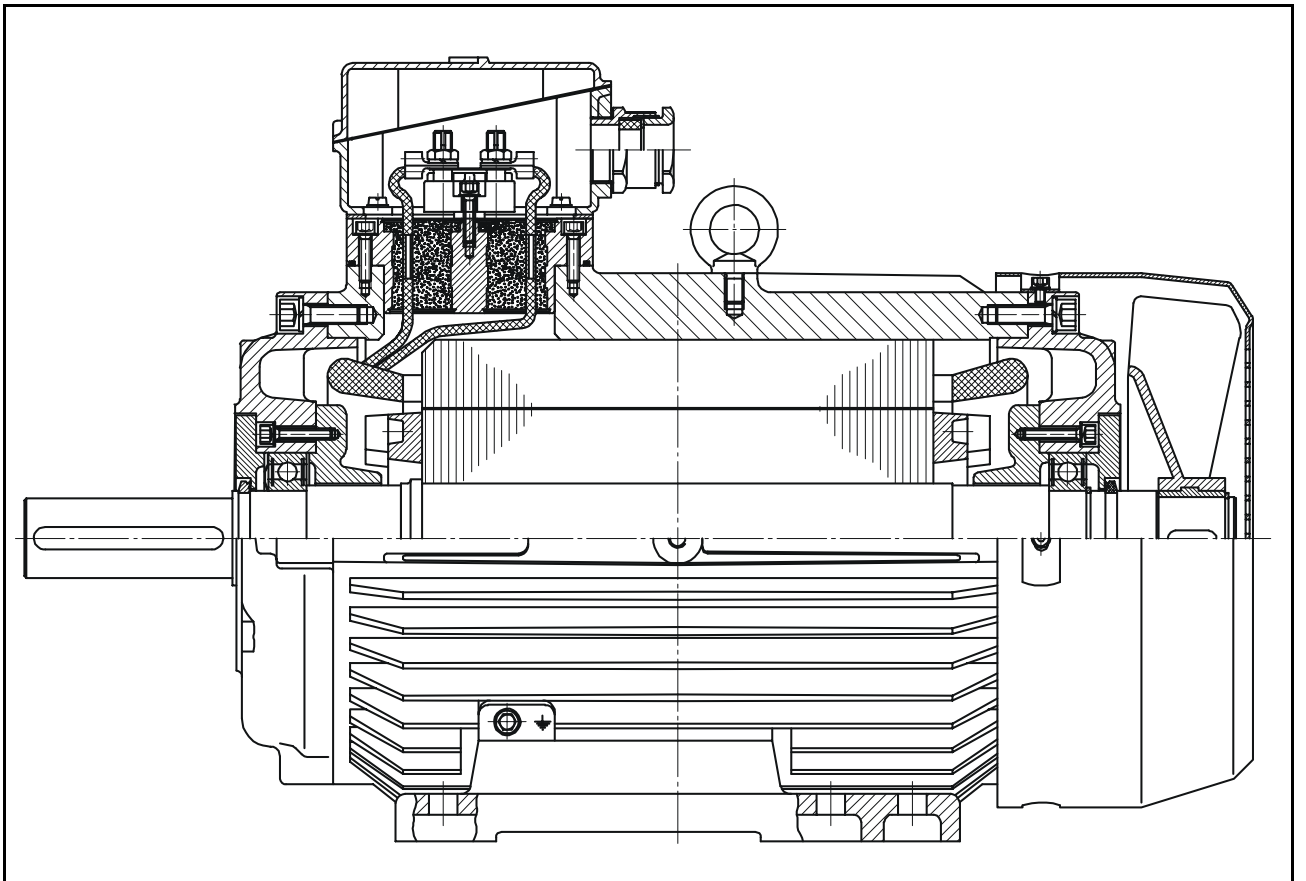

Fig. 2.

Fig. 3.



Assembly drawings - el.motor in explosion-proof protection, cast iron design with flameproof bushings,  
EExde I, EExde II B



Assembly drawings - el.motor in explosion-proof protection, cast iron design with molded outlet leads,  
EExde II B

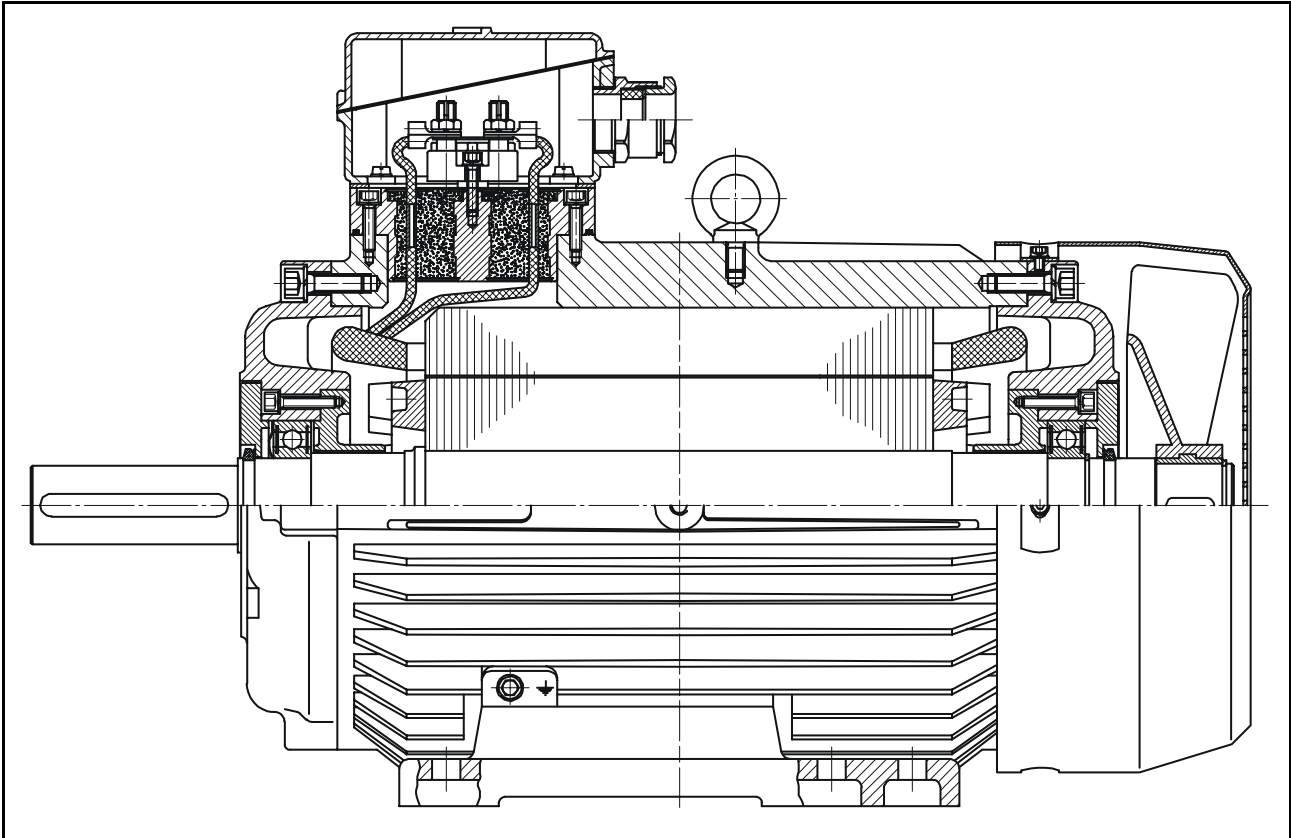

Assembly drawings - el.motor in explosion-proof protection, cast iron design with molded outlet leads,  
EExde II C

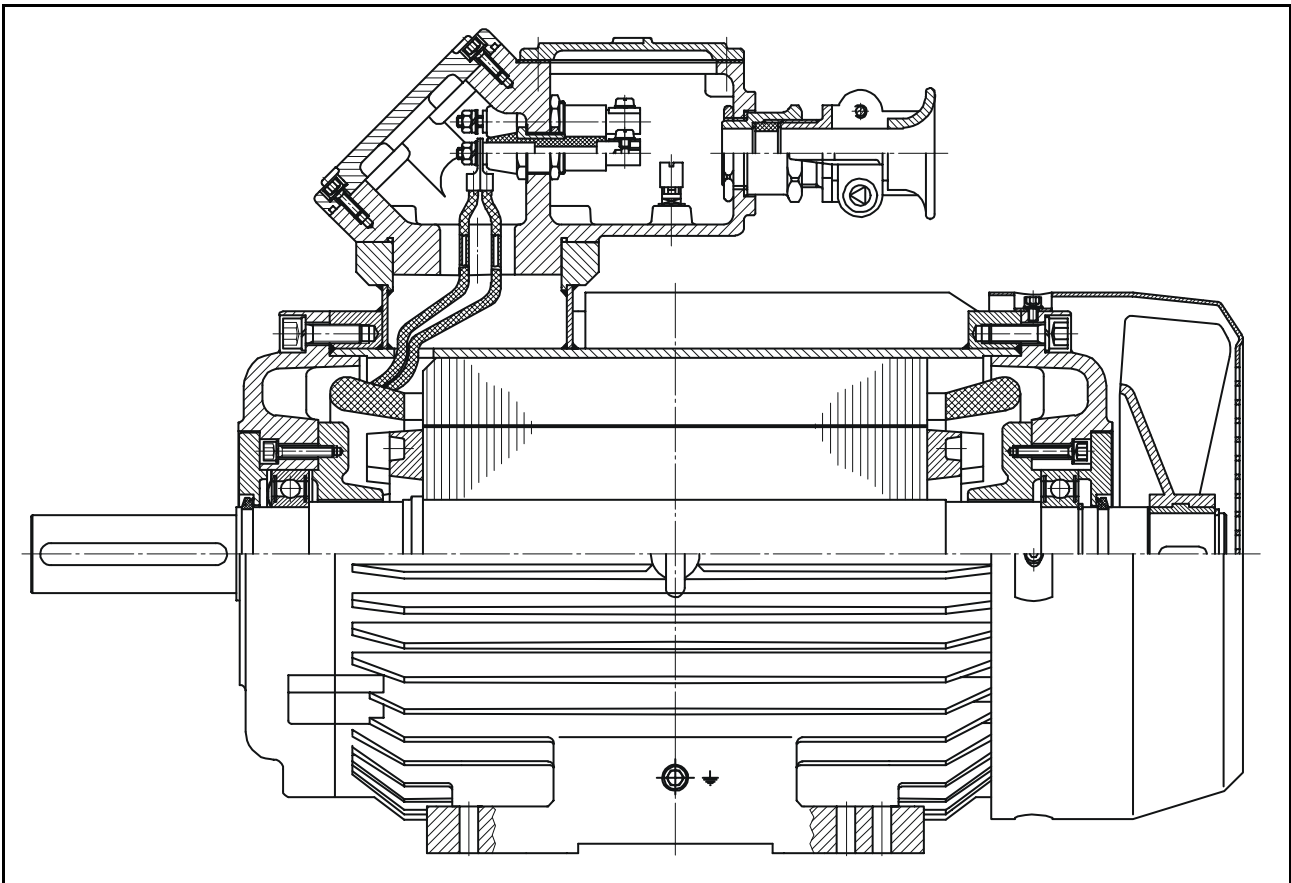

Assembly drawings - el.motor in explosion-proof protection, welded design with flameproof bushings,  
EExde I, EExde II B

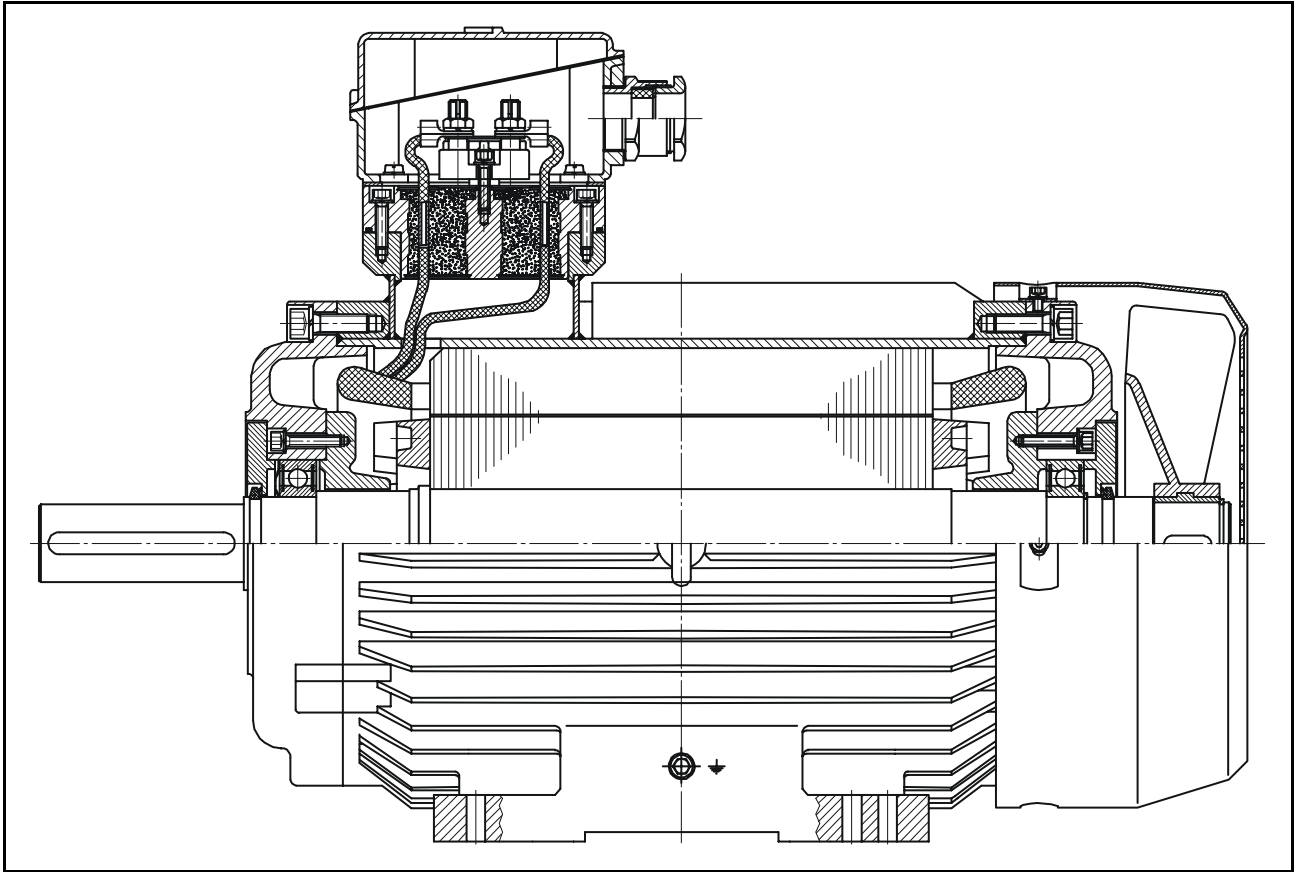

Assembly drawings - el.motor in explosion-proof protection, welded design with molded outlet leads,  
EExde II B

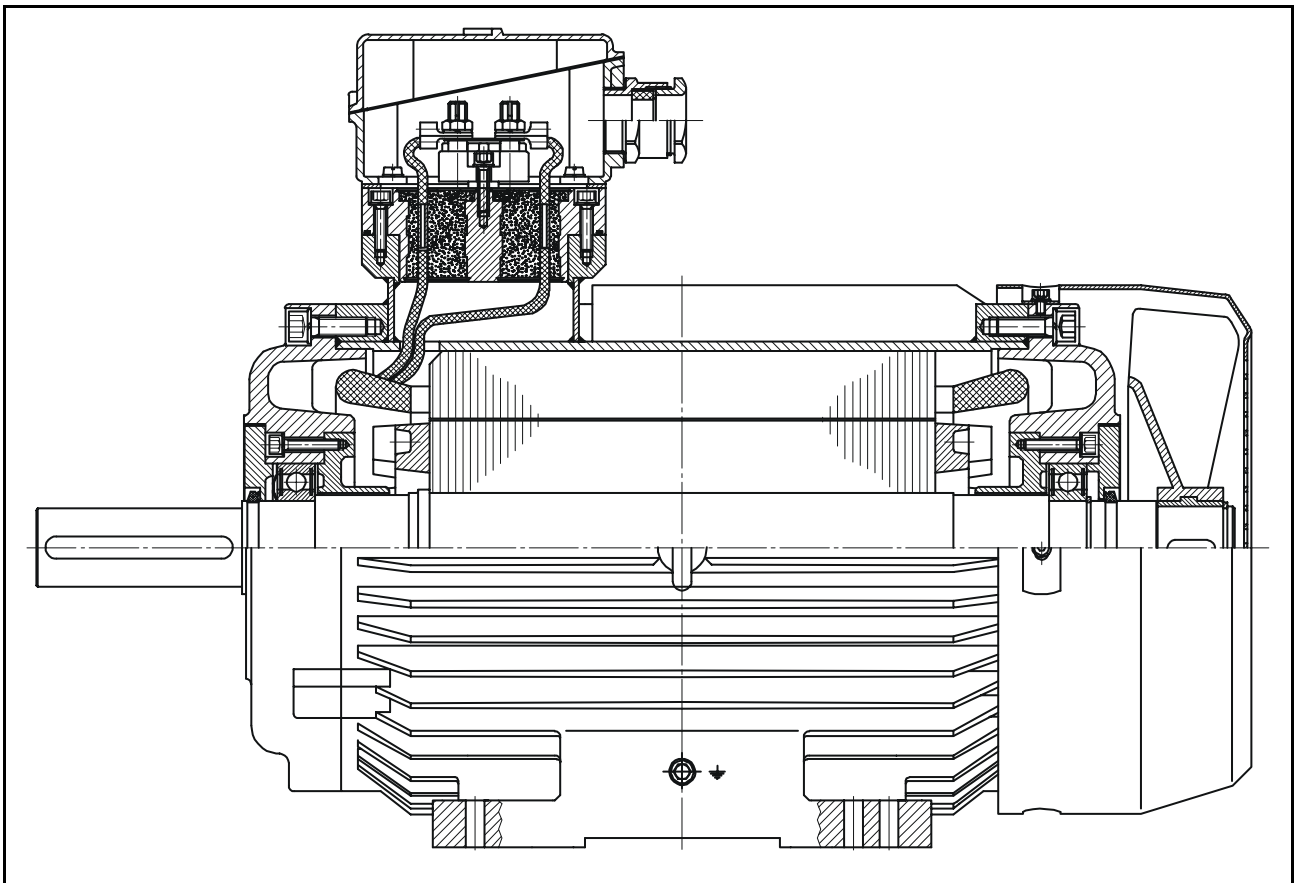

Assembly drawings - el.motor in explosion-proof protection, welded design with molded outlet leads,  
EExde II C

### 3.2.3 Bearing arrangement

Shaft of electric motor is arranged with roller bearings without possibility of re-lubrication. Motors of frame size 71 - 132 have non-fixed bearings on both sides, while the motors of frame size 160 - 315 have fixed fan side (BS) bearing and non-fixed drive side (AS) bearing. Types of bearings for normal duty conditions are given in the following table.

Frame size	Num. of poles	AS bearing	BS bearing
71	2,4,6,8	6203 2Z	6203 2Z
80	2,4,6,8	6204 2Z	6204 2Z
90	2,4,6,8	6205 2Z	6205 2Z
100	2,4,6,8	6206 2Z	6206 2Z
112	2,4,6,8	6206 2Z	6206 2Z
132	2,4,6,8	6208 2Z	6208 2Z
160	2,4,6,8	6210 2Z	6210 2Z
180	2,4,6,8	6310 2Z	6310 2Z
200	2,4,6,8	6312 2Z	6312 2Z
225	2,4,6,8	6314 2Z	6314 2Z
250	2,4,6,8	6315 2Z	6315 2Z
280	2,4,6,8	6316 2Z	6316 2Z
315	2,4,6,8	6317 2Z	6317 2Z

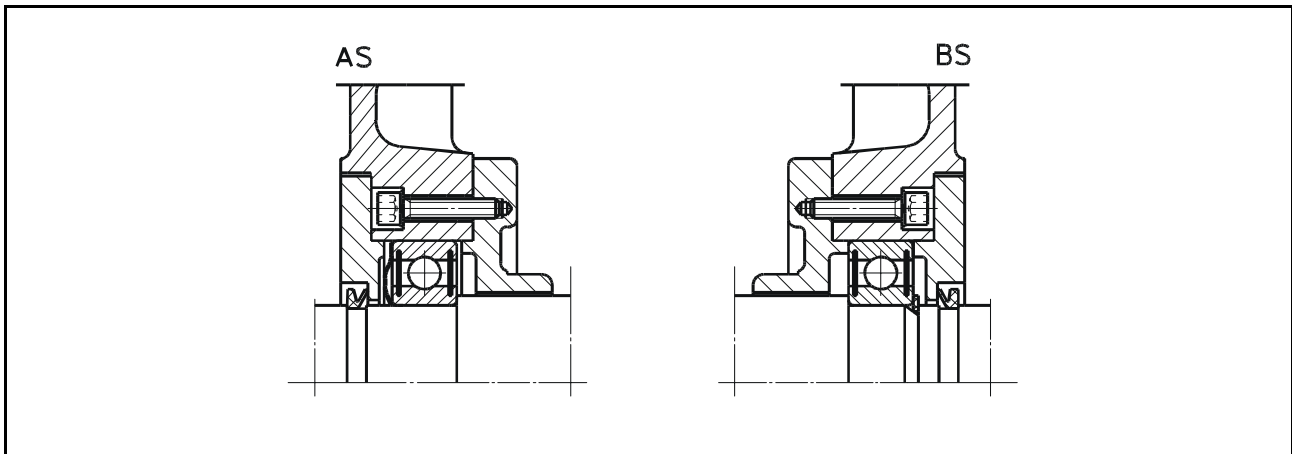

Bearing arrangement of electric motors in flameproof enclosure EExde I, EExde IIB

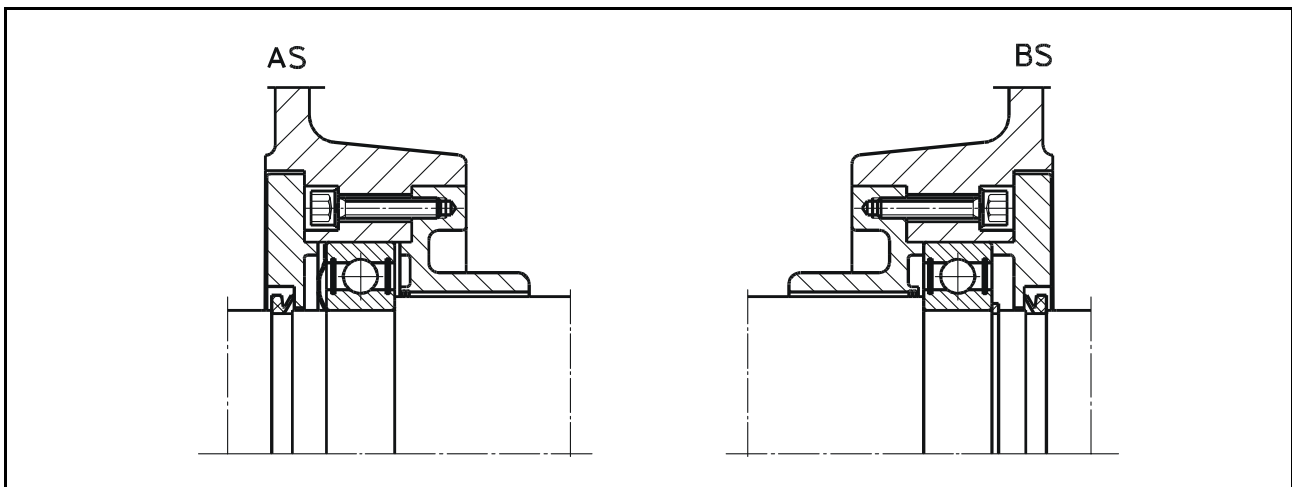

Bearing arrangement of electric motors in flameproof enclosure EExde IIC

## 3.3 TECHNICAL DATA FOR SINGLE-SPEED MOTORS SELECTION

3000 min<sup>-1</sup>, 400 V, 50 Hz, Insulation class: F, Mechanical protection IP 55

Type	Output [kW]	n [min <sup>-1</sup> ]	η [%]	cos φ	I <sub>N</sub> [A]	M <sub>N</sub> [Nm]	$\frac{I_p}{I_N}$	$\frac{M_p}{M_N}$	$\frac{M_m}{M_N}$	KR	J [kgm <sup>4</sup> ]	Mass [kg]	
St 1.ZK 71	A-2	0,37	2750	63	0,81	1,05	1,3	3,5	2,0	-	16	0,00023	16
	B-2	0,55	2760	69	0,81	1,43	1,9	4,2	2,2	-	16	0,00033	18
St 1.ZK 80	A-2	0,75	2770	72	0,80	1,87	2,6	4,8	2,3	-	16	0,00055	23
	B-2	1,1	2770	73	0,84	2,58	3,8	4,7	2,3	-	16	0,00066	24
St 1.ZK 90	S-2	1,5	2810	74	0,85	3,42	5,1	5,3	2,3	-	16	0,00123	28
	L-2	2,2	2830	80	0,85	4,66	7,4	6,3	2,9	-	16	0,00184	30
St 1.ZK 100	L-2	3	2830	80	0,86	6,27	10,0	6,5	2,4	2,6	16	0,003	38
St 1.ZK 112	M-2	4	2830	82	0,90	7,80	13,5	7,6	3,2	3,3	16	0,005	52
St 1.ZK 132	Sk-2	5,5	2840	82	0,90	10,74	18,5	7,5	3,6	3,8	16	0,01	81
	S-2	7,5	2860	84	0,90	14,25	25,0	8,0	3,7	4,0	16	0,013	87
St 1.ZK 160	Mk-2	11	2890	86	0,87	21	36	8,5	3,7	3,9	16	0,021	89
	M-2	15	2900	87	0,87	28	49	8,5	3,7	3,9	16	0,028	108
	L-2	18,5	2905	88	0,88	34	61	8,9	3,7	3,9	16	0,034	113
St 1.ZK 180	M-2	22	2920	89	0,87	41	72	8,0	3,5	3,4	16	0,057	138
St 1.ZK 200	Lk-2	30	2935	89,5	0,87	47	98	8,5	3,1	3,1	16	0,11	199
	L-2	37	2940	90	0,88	66	120	7,9	3,4	3,2	16	0,13	215
St 1.ZK 225	M-2	45	2960	92	0,88	80	145	7,5	2,7	4,9	16	0,23	290
St 1.ZK 250	M-2	55	2960	93	0,88	97	177	7,5	2,5	3,0	16	0,36	395
St 1.ZK 280	S-2	75	2960	93	0,90	130	242	7,5	2,1	4,8	16	0,67	510
	M-2	90	2965	93,5	0,89	158	290	7,5	2,4	3,0	16	0,81	600
St 1.ZK 315	S-2	110	2970	93,5	0,92	186	420	8,0	2,5	3,2	16	1,3	700
	M-2	132	2975	94	0,92	222	510	8,0	2,5	3,2	16	1,6	850

1500 min<sup>-1</sup>, 400 V, 50 Hz, Insulation class: F, Mechanical protection IP 55

Type	Output [kW]	n [min <sup>-1</sup> ]	η [%]	cos φ	I <sub>N</sub> [A]	M <sub>N</sub> [Nm]	$\frac{I_p}{I_N}$	$\frac{M_p}{M_N}$	$\frac{M_m}{M_N}$	KR	J [kgm <sup>4</sup> ]	Mass [kg]	
St 1.ZK 71	A-4	0,25	1345	63	0,76	0,75	1,77	3,2	1,7	1,9	13	0,00038	16
	B-4	0,37	1370	66	0,75	1,07	2,58	3,5	2,0	2,1	13	0,00055	18
St 1.ZK 80	A-4	0,55	1375	69	0,76	1,51	3,8	3,5	1,8	1,9	13	0,0009	23
	B-4	0,75	1375	71	0,75	2,02	5,2	3,7	2,0	2,1	13	0,0011	24
St 1.ZK 90	S-4	1,1	1410	74	0,78	2,76	7,5	4,5	2,0	2,2	16	0,0023	29
	L-4	1,5	1405	76	0,79	3,61	10	4,9	2,3	2,6	16	0,0032	30
St 1.ZK 100	L-4	2,2	1410	78	0,81	5,04	15	5,9	2,4	2,8	16	0,0054	41
	Ld-4	3	1410	76	0,80	7,13	20	6,2	2,7	2,9	16	0,0071	50
St 1.ZK 112	M-4	4	1420	81	0,82	8,65	27	6,5	2,9	3,2	16	0,013	64
St 1.ZK 132	S-4	5,5	1450	85	0,82	11,40	36	6,2	2,0	2,7	16	0,019	83
	M-4	7,5	1450	86	0,80	15,68	49	6,5	2,2	2,9	16	0,025	91
St 1.ZK 160	M-4	11	1440	88	0,82	22	73	6,5	3,0	3,0	16	0,055	89
	L-4	15	1440	88	0,82	30	100	6,8	3,0	3,0	16	0,073	118
St 1.ZK 180	M-4	18,5	1460	89	0,82	36	121	6,5	2,8	2,6	16	0,086	140
	L-4	22	1460	90	0,83	42	144	6,5	2,8	2,6	16	0,102	155
St 1.ZK 200	L-4	30	1470	90	0,83	58	195	7,5	2,9	2,8	16	0,27	230
St 1.ZK 225	S-4	37	1470	92	0,86	68	240	6,5	2,3	2,5	16	0,362	280
	M-4	45	1470	92	0,86	82	292	6,5	2,3	2,5	16	0,442	320
St 1.ZK 250	M-4	55	1480	92,5	0,87	100	355	6,8	2,3	2,7	16	0,64	385
St 1.ZK 280	S-4	75	1480	93	0,87	135	486	7,5	2,6	2,8	16	1,10	525
	M-4	90	1480	93,5	0,87	162	581	7,5	2,6	2,8	16	1,31	610
St 1.ZK 315	S-4	110	1485	94	0,90	190	710	7,5	2,4	3,0	16	2,12	750
	M-4	132	1480	94,3	0,90	226	850	7,5	2,4	3,0	16	2,54	900

I<sub>n</sub> - Rated CurrentI<sub>p</sub> - Locked-rotor CurrentM<sub>n</sub> - Rated TorqueM<sub>m</sub> - Breakdown TorqueM<sub>p</sub> - Locked-rotor Torque

KR - Rotor class

1000 min<sup>-1</sup>, 400 V, 50 Hz, Insulation class: F, Mechanical protection: IP 55

Type	Output [kW]	n [min <sup>-1</sup> ]	η [%]	cos φ	I <sub>N</sub> [A]	M <sub>N</sub> [Nm]	$\frac{I_p}{I_N}$	$\frac{M_p}{M_N}$	$\frac{M_m}{M_N}$	KR	J [kgm <sup>4</sup> ]	Mass [kg]	
St 1.ZK 71	A-6	0,18	900	57	0,65	0,70	1,9	2,6	1,9	2,0	13	0,00055	18
	B-6	0,25	890	57	0,64	0,99	2,7	2,6	1,8	2,1	13	0,00071	20
St 1.ZK 80	A-6	0,37	915	66	0,69	1,17	3,9	3,6	2,0	2,2	13	0,0018	24
	B-6	0,55	915	68	0,66	1,77	5,7	3,7	2,4	2,5	13	0,0024	26
St 1.ZK 90	S-6	0,75	920	70	0,72	2,14	7,8	3,8	2,0	2,2	16	0,0037	29
	L-6	1,1	920	70	0,70	3,33	11,2	3,8	2,2	2,4	16	0,0054	31
St 1.ZK 100	L-6	1,5	910	71	0,75	4,09	15,7	4,2	2,2	2,4	13	0,0054	41
St 1.ZK 112	M-6	2,2	925	76	0,75	5,61	22,7	4,8	2,5	2,9	16	0,012	58
St 1.ZK 132	S-6	3	945	81	0,76	7,03	30,3	4,5	2,0	2,4	13	0,015	77
	Mk-6	4	950	82	0,77	9,12	40,2	4,5	1,9	2,0	13	0,02	85
	M-6	5,5	950	83	0,77	12,35	55,3	4,5	1,9	2,1	13	0,028	96
St 1.ZK 160	M-6	7,5	950	84	0,78	16,5	75	5,5	2,0	2,4	16	0,049	90
	L-6	11	950	86	0,78	24	110	6,0	2,2	2,5	16	0,070	120
St 1.ZK 180	L-6	15	960	87,5	0,83	29	149	6,0	2,2	2,7	16	0,144	150
St 1.ZK 200	Lk-6	18,5	970	89	0,83	36	182	6,5	2,0	2,7	16	0,225	205
	L-6	22	970	90	0,83	43	417	6,5	2,0	2,7	16	0,27	230
St 1.ZK 225	M-6	30	975	91	0,84	57	494	6,5	2,0	2,7	16	0,656	330
St 1.ZK 250	M-6	37	980	91	0,85	69	361	6,0	2,0	2,2	13	0,9	390
St 1.ZK 280	S-6	45	982	92,5	0,87	82	438	6,9	2,4	2,8	16	1,5	500
	M-6	55	985	93	0,87	98	533	6,9	2,3	2,6	16	1,82	560
St 1.ZK 315	S-6	75	985	93	0,87	135	727	7,5	2,4	2,7	16	2,7	750
	M-6	90	985	93,5	0,88	159	872	7,5	2,4	2,7	16	3,2	900

750 min<sup>-1</sup>, 400 V, 50 Hz, Insulation class: F, Mechanical protection IP 55

Type	Output [kW]	n [min <sup>-1</sup> ]	η [%]	cos φ	I <sub>N</sub> [A]	M <sub>N</sub> [Nm]	$\frac{I_p}{I_N}$	$\frac{M_p}{M_N}$	$\frac{M_m}{M_N}$	KR	J [kgm <sup>4</sup> ]	Mass [kg]	
St 1.ZK 71	A-8	0,09	670	43	0,50	0,60	1,28	2,2	1,8	2,0	16	0,00055	18
	B-8	0,12	680	46	0,50	0,75	1,68	2,0	1,9	2,2	16	0,00071	20
St 1.ZK 80	A-8	0,18	680	55	0,55	0,86	2,53	2,8	2,2	2,5	16	0,0018	24
	B-8	0,25	690	57	0,56	1,13	3,46	2,8	2,3	2,5	16	0,0024	26
St 1.ZK 90	S-8	0,37	700	59	0,62	1,45	5,05	2,9	1,9	2,0	13	0,0037	29
	L-8	0,55	700	61	0,61	2,13	7,50	3,0	2,1	2,3	13	0,0054	31
St 1.ZK 100	L-8	0,75	690	64	0,67	2,52	10,4	3,7	2,0	2,4	13	0,0054	41
	Ld-8	1,1	670	64	0,70	3,52	15,7	3,5	2,1	2,4	13	0,0071	50
St 1.ZK 112	M-8	1,5	680	70	0,71	4,37	21,0	3,6	2,0	2,2	13	0,012	58
St 1.ZK 132	S-8	2,2	705	76	0,69	6,08	29,8	3,6	1,6	2,0	13	0,015	77
	M-8	3	710	79	0,69	7,89	40,4	3,5	1,6	1,9	13	0,028	96
St 1.ZK 160	Mk-8	4	690	78	0,68	10,8	54	4,7	2,1	2,4	13	0,037	87
	M-8	5,5	700	79	0,68	14,7	74	4,7	2,1	2,4	13	0,053	91,5
	L-8	7,5	710	81	0,70	19	101	4,9	2,1	2,4	13	0,076	122
St 1.ZK 180	L-8	11	715	84	0,74	25	148	4,8	2,1	2,3	13	0,16	160
St 1.ZK 200	L-8	15	720	87	0,73	34	199	5,5	2,0	2,4	13	0,225	205
St 1.ZK 225	S-8	18,5	735	88,5	0,78	39	240	5,3	1,9	2,4	13	0,47	245
	M-8	22	735	89,5	0,77	45,5	286	5,3	1,8	2,5	13	0,56	285
St 1.ZK 250	M-8	30	735	90	0,80	61	390	5,5	1,8	2,4	13	0,87	370
St 1.ZK 280	S-8	37	735	92	0,80	72	481	5,6	1,8	2,2	13	1,5	495
	M-8	45	735	92	0,81	87	585	5,6	1,8	2,2	13	1,82	580
St 1.ZK 315	S-8	55	740	92,5	0,82	104	710	7,1	2,0	3,0	13	2,56	750
	M-8	75	740	93	0,83	141	970	6,6	1,8	4,8	13	3,32	870

I<sub>n</sub> - Rated CurrentI<sub>p</sub> - Locked-rotor CurrentM<sub>n</sub> - Rated TorqueM<sub>m</sub> - Breakdown TorqueM<sub>p</sub> - Locked-rotor Torque

KR - Rotor class



### 3.4 TECHNICAL DATA FOR TWO-SPEED MOTORS SELECTION

400 V, 50 Hz, Insulation class: F, Mechanical protection IP 55, Temperature class T1-T4

#### Dahlander winding $\Delta/Y$

1500/3000 min<sup>-1</sup>

Type		Output [kW]		n [min <sup>-1</sup> ]	
		2p=4	2p=2	2p=4	2p=2
St 1.ZK 71	A-4/2	0,21	0,28	1400	2800
	B-4/2	0,3	0,43	1410	2840
St 1.ZK 80	A-4/2	0,48	0,6	1410	2720
	B-4/2	0,7	0,85	1405	2800
St 1.ZK 90	S-4/2	1,0	1,4	1400	2800
	L-4/2	1,3	1,75	1400	2780
St 1.ZK 100	L-4/2	1,8	2,4	1400	2790
	Ld-4/2	2,4	3,0	1400	2800
St 1.ZK 112	M-4/2	3,0	4,0	1400	2830
St 1.ZK 132	S-4/2	4,5	5,7	1440	2830
	M-4/2	6,1	7,5	1450	2860
St 1.ZK 160	M-4/2	9	10,5	1450	2920
	L-4/2	12	15	1450	2920
St 1.ZK 180	M-4/2	14	17	1460	2920
	L-4/2	17	20	1460	2940
St 1.ZK 200	L-4/2	20	26	1460	2940
St 1.ZK 225	S-4/2	24	28	1480	2940
	M-4/2	29	34	1480	2970
St 1.ZK 250	M-4/2	36	45	1480	2970

750/1500 min<sup>-1</sup>

Type		Output [kW]		n [min <sup>-1</sup> ]	
		2p=8	2p=4	2p=8	2p=4
St 1.ZK 80	A-8/4	0,14	0,28	680	1400
	B-8/4	0,22	0,37	680	1420
St 1.ZK 90	S-8/4	0,42	0,8	680	1390
	L-8/4	0,5	1,0	680	1390
St 1.ZK 100	L-8/4	0,8	1,6	680	1390
	Ld-8/4	1,0	1,9	670	1390
St 1.ZK 112	M-8/4	1,3	2,3	690	1300
St 1.ZK 132	S-8/4	2,2	3,4	700	1400
	M-8/4	2,7	4,3	710	1450
St 1.ZK 160	Mk-8/4	4	5,5	710	1440
	M-8/4	4,6	7,3	712	1440
St 1.ZK 180	L-8/4	6,8	11	712	1440
	L-8/4	11	15	712	1455
St 1.ZK 200	L-8/4	15	20	725	1470
St 1.ZK 225	S-8/4	18	24	735	1480
	M-8/4	22	28	735	1480
St 1.ZK 250	M-8/4	30	42	740	1480

#### With two separate windings Y/Y

1000/1500 min<sup>-1</sup>

Type		Output [kW]		n [min <sup>-1</sup> ]	
		2p=6	2p=4	2p=6	2p=4
St 1.ZK 80	A-6/4	0,22	0,32	940	1415
	B-6/4	0,26	0,4	940	1440
St 1.ZK 90	S-6/4	0,45	0,66	940	1440
	L-6/4	0,6	0,9	940	1440
St 1.ZK 100	L-6/4	0,9	1,3	940	1440
St 1.ZK 112	M-6/4	1,2	1,8	940	1440
St 1.ZK 132	S-6/4	1,7	2,7	960	1440
	M-6/4	2,4	3,7	965	1450
St 1.ZK 160	M-6/4	3,8	5,7	965	1460
	L-6/4	5,5	8	970	1460
St 1.ZK 180	M-6/4	7,5	11	970	1480
	L-6/4	9	13	970	1470
St 1.ZK 200	L-6/4	13	19	980	1470
St 1.ZK 225	S-6/4	19	23	985	1480
	M-6/4	23	27	985	1480
St 1.ZK 250	M-6/4	27	32	985	1485

750/1000 min<sup>-1</sup>

Type		Output [kW]		n [min <sup>-1</sup> ]	
		2p=8	2p=6	2p=8	2p=6
St 1.ZK 90	S-8/6	0,35	0,45	690	945
	L-8/6	0,45	0,6	690	945
St 1.ZK 100	L-8/6	0,6	0,8	680	940
	Ld-8/6	0,75	0,9	700	960
St 1.ZK 112	M-8/6	0,9	1,2	700	950
St 1.ZK 132	S-8/6	1,4	2	710	960
	M-8/6	2,2	3	715	970
St 1.ZK 160	M-8/6	3,5	5	715	970
	L-8/6	5	7	715	970
St 1.ZK 180	L-8/6	7	9,5	730	980
St 1.ZK 200	L-8/6	10	13	730	980
St 1.ZK 225	L-8/6	13	16	730	985
	S-8/6	17	22	735	985
St 1.ZK 250	M-8/6	22	30	735	985

It is important to indicate supply voltage and frequency when ordering certain motor designs.

## 3.5 OUTLINE DRAWINGS

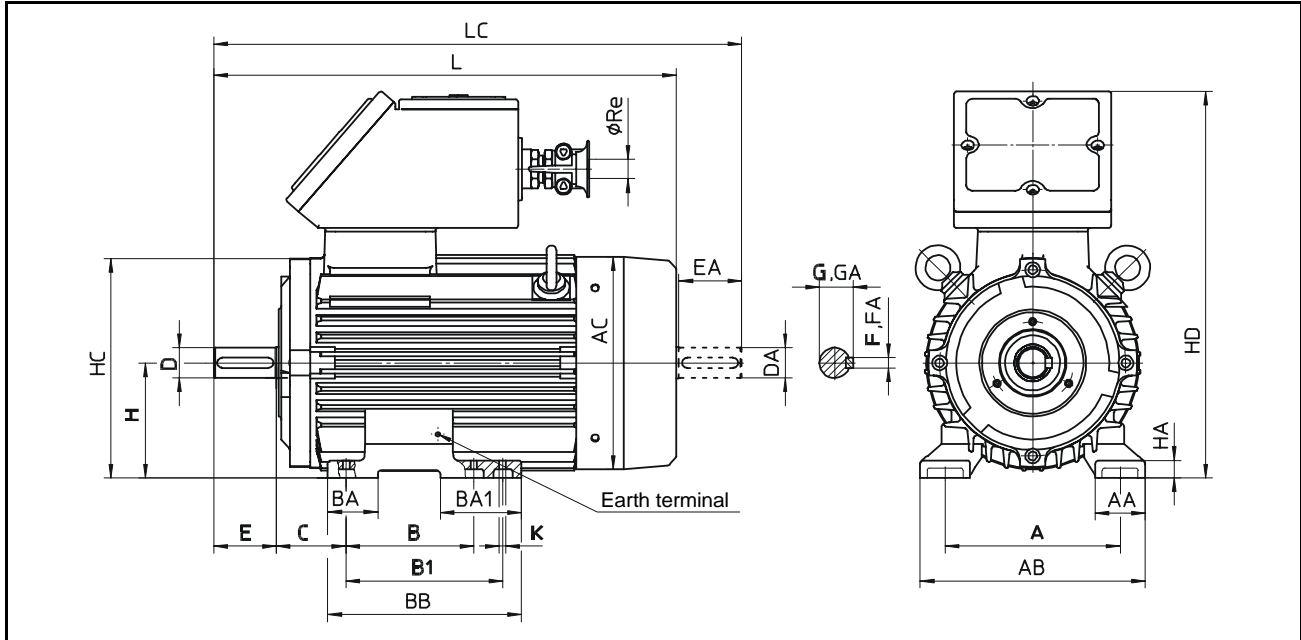
Type: **St 1.ZK**Protection: **EExd I, EExde II B**Temperature class: **T1 - T4****IM B3 - IM 1001**

Type	Pole	A	AA	AB	AC	B	B1	BA	BA1	BB	C	D	DA	E	EA	F	FA	GA	GC	H	HA	HC	HD	K	L	LC	Cable gland with trumpet		
St 1.ZK 71	2,4,6,8	<b>112</b>	34	142	140	<b>90</b>	-	-	-	114	<b>45</b>	<b>14</b>	14	<b>30</b>	30	<b>5</b>	<b>5</b>	<b>16</b>	16	<b>71</b>	8	142	242	<b>7</b>	278	310	Re 16		
St 1.ZK 80	2,4,6,8	<b>125</b>	38	155	154	<b>100</b>	-	-	-	130	<b>50</b>	<b>19</b>	19	<b>40</b>	40	<b>6</b>	<b>6</b>	<b>21,5</b>	21,5	<b>80</b>	9	157	262	<b>10</b>	316	358	Re 16		
St 1.ZK 90	S	2,4,6,8	<b>140</b>	40	180	170	<b>100</b>	-	-	40	65	155	<b>56</b>	<b>24</b>	24	<b>50</b>	50	<b>8</b>	8	<b>27</b>	27	<b>90</b>	12	174	306	<b>10</b>	370	422	Re 16
	L						-	<b>125</b>																					
St 1.ZK 100	L	2,4,6,8	<b>160</b>	46	204	193	<b>140</b>	-	50	50	175	<b>63</b>	<b>28</b>	28	<b>60</b>	60	<b>8</b>	8	<b>31</b>	31	<b>100</b>	14	195	326	<b>12</b>	432	494	Re 16	
	Ld																												4,6,8
St 1.ZK 112	M	2,4,6,8	<b>190</b>	46	236	216	<b>140</b>	-	50	50	175	<b>70</b>	<b>28</b>	28	<b>60</b>	60	<b>8</b>	8	<b>31</b>	31	<b>112</b>	16	218	345	<b>12</b>	435	497	Re 21	
St 1.ZK 132	Sk	2	<b>216</b>	55	271	247	<b>140</b>	-	50	93	218	<b>89</b>	<b>38</b>	38	<b>80</b>	80	<b>10</b>	10	<b>41</b>	41	<b>132</b>	20	250	378	<b>12</b>	535	617	Re 21	
	S	2,4,6,8																											
	Mk	6																											
	M	4,6,8																											

Mounting dimensions given in bold figures are obligatory in the sense of IEC recommendations.

Type: **St 1.ZK**  
 Protection: **EExd II C**  
 Temperature class: **T1 - T4**

**IM B3 - IM 1001**

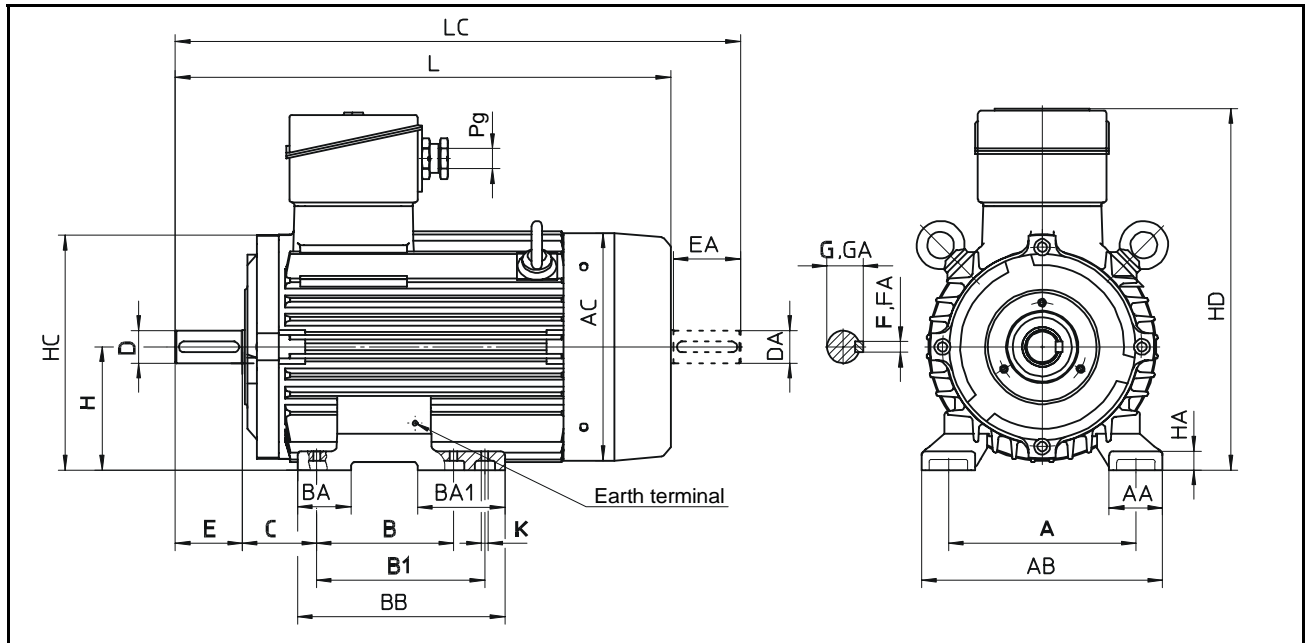

Type	Pole	A	AA	AB	AC	B	B1	BA	BA1	BB	C	D	DA	E	EA	F	FA	GA	GC	H	HA	HC	HD	K	L	LC	Cable gland		
St 1.ZK 71	2,4,6,8	<b>112</b>	34	142	140	<b>90</b>	-	-	-	114	<b>45</b>	<b>14</b>	14	<b>30</b>	30	<b>5</b>	5	<b>16</b>	16	<b>71</b>	8	142	218	<b>7</b>	278	310	Pg 13,5		
St 1.ZK 80	2,4,6,8	<b>125</b>	38	155	154	<b>100</b>	-	-	-	130	<b>50</b>	<b>19</b>	19	<b>40</b>	40	<b>6</b>	6	<b>21,5</b>	21,5	<b>80</b>	9	157	236	<b>10</b>	316	358	Pg 13,5		
St 1.ZK 90	S	2,4,6,8	<b>140</b>	40	180	170	<b>100</b>	-	-	40	65	155	<b>56</b>	<b>24</b>	24	<b>50</b>	50	<b>8</b>	8	<b>27</b>	27	<b>90</b>	12	174	282	<b>10</b>	370	422	Pg 13,5
	L	2,4,6,8	<b>140</b>	40	180	170	<b>125</b>	-	-	40	65	155	<b>56</b>	<b>24</b>	24	<b>50</b>	50	<b>8</b>	8	<b>27</b>	27	<b>90</b>	12	174	282	<b>10</b>	370	422	Pg 13,5
St 1.ZK 100	L	2,4,6,8	<b>160</b>	46	204	193	<b>140</b>	-	50	50	175	<b>63</b>	<b>28</b>	28	<b>60</b>	60	<b>8</b>	8	<b>31</b>	31	<b>100</b>	14	195	298	<b>12</b>	432	494	Pg 13,5	
	Ld	4,6,8	<b>160</b>	46	204	193	<b>140</b>	-	50	50	175	<b>63</b>	<b>28</b>	28	<b>60</b>	60	<b>8</b>	8	<b>31</b>	31	<b>100</b>	14	195	298	<b>12</b>	432	494	Pg 13,5	
St 1.ZK 112	M	2,4,6,8	<b>190</b>	46	236	216	<b>140</b>	-	50	50	175	<b>70</b>	<b>28</b>	28	<b>60</b>	60	<b>8</b>	8	<b>31</b>	31	<b>112</b>	16	218	327	<b>12</b>	435	497	Pg 21	
St 1.ZK 132	Sk	2				<b>140</b>	-																						
	S	2,4,6,8	<b>216</b>	55	271	247			50	93	218	<b>89</b>	<b>38</b>	38	<b>80</b>	80	<b>10</b>	10	<b>41</b>	41	<b>132</b>	20	250	360	<b>12</b>	535	617	Pg 21	
	Mk	6																											
	M	4,6,8																											

Mounting dimensions given in bold figures are obligatory in the sense of IEC recommendations.

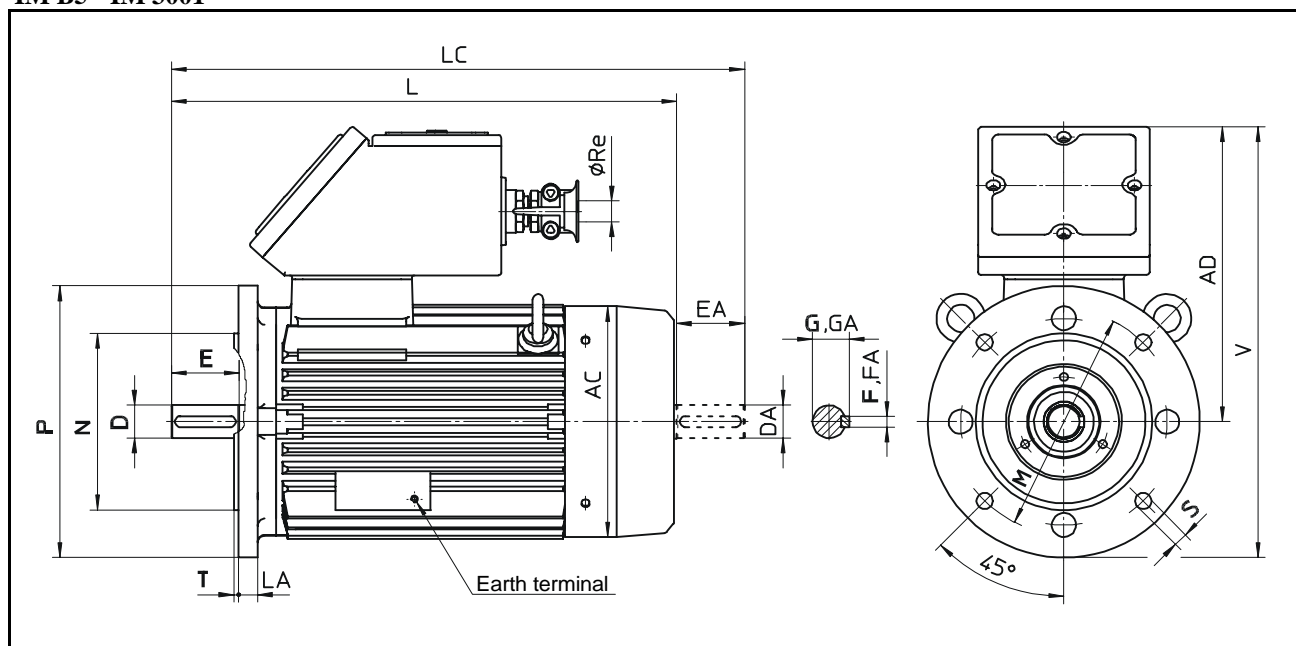
Type: **St 1.ZK**Protection: **EExd I, EExde II B**Temperature class: **T1 - T4****IM B5 - IM 3001**

Type	Pole	Flange	AC	AD	<b>D</b>	DA	<b>E</b>	EA	<b>F</b>	FA	<b>GA</b>	GC	L	LA	LC	<b>M</b>	<b>N</b>	<b>P</b>	<b>S</b>	Num.of holes	T	V	Cable gland with trumpet	
St 1.ZK 71	2,4,6,8	FF 130	140	171	<b>14</b>	14	<b>30</b>	30	<b>5</b>	5	<b>16</b>	16	278	12	310	<b>130</b>	<b>110</b>	<b>160</b>	<b>10</b>	4	<b>3,5</b>	251	Re 16	
St 1.ZK 80	2,4,6,8	FF165	154	182	<b>19</b>	19	<b>40</b>	40	<b>6</b>	6	<b>21,5</b>	21,5	316	14	358	<b>165</b>	<b>130</b>	<b>200</b>	<b>12</b>	4	<b>3,5</b>	282	Re 16	
St 1.ZK 90	S	2,4,6,8	FF 165	170	216	<b>24</b>	24	<b>50</b>	50	<b>8</b>	8	<b>27</b>	27	370	16	422	<b>165</b>	<b>130</b>	<b>200</b>	<b>12</b>	4	<b>3,5</b>	316	Re 16
	L																							
St 1.ZK 100	L	2,4,6,8	FF 215	193	226	<b>28</b>	28	<b>60</b>	60	<b>8</b>	8	<b>31</b>	31	432	18	494	<b>215</b>	<b>180</b>	<b>250</b>	<b>15</b>	4	<b>4</b>	351	Re 16
	Ld	4,6,8																						
St 1.ZK 112	M	2,4,6,8	FF 215	216	233	<b>28</b>	28	<b>60</b>	60	<b>8</b>	8	<b>31</b>	31	435	18	497	<b>215</b>	<b>180</b>	<b>250</b>	<b>15</b>	4	<b>4</b>	358	Re 21
St 1.ZK 132	Sk	2	FF 265	247	246	<b>38</b>	38	<b>80</b>	80	<b>10</b>	10	<b>41</b>	41	535	18	617	<b>265</b>	<b>230</b>	<b>300</b>	<b>15</b>	4	<b>4</b>	396	Re 21
	S	2,4,6,8																						
	Mk	6																						
	M	4,6,8																						

Mounting dimensions given in bold figures are obligatory in the sense of IEC recommendations.

Type: **St 1.ZK**  
 Protection: **EExde II C**  
 Temperature class: **T1 - T4**

**IM B5 - IM 3001**

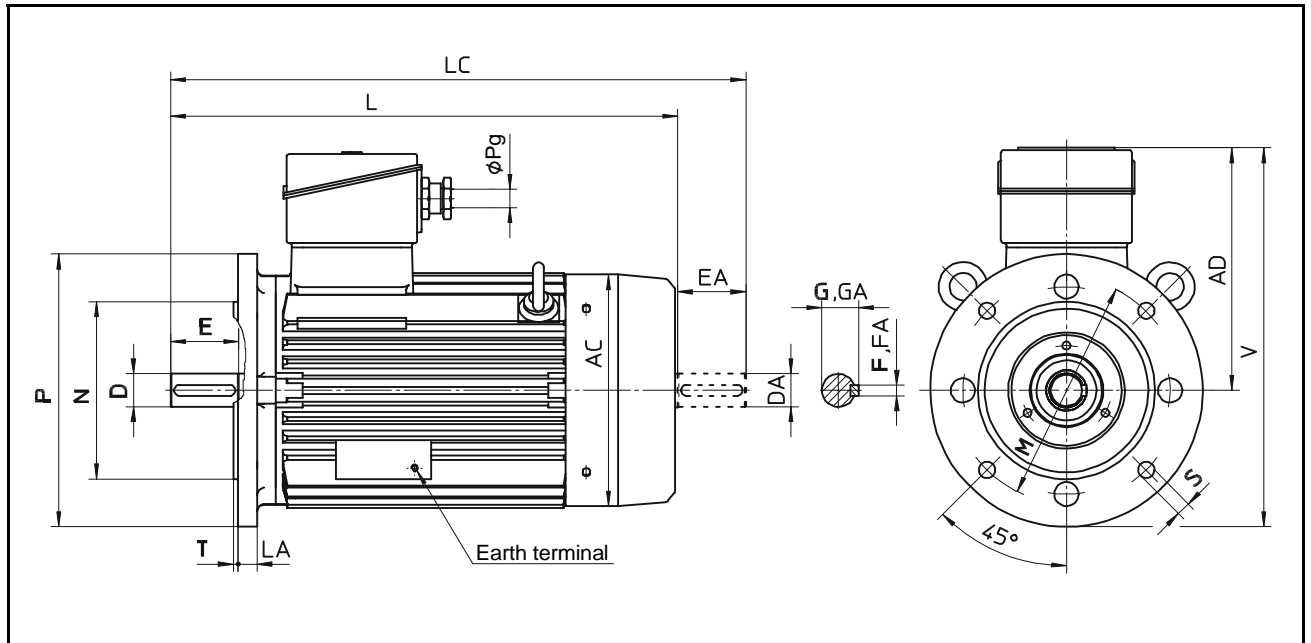

Type	Pole	Flange	AC	AD	<b>D</b>	DA	<b>E</b>	EA	<b>F</b>	FA	<b>GA</b>	GC	L	LA	LC	<b>M</b>	<b>N</b>	<b>P</b>	<b>S</b>	Num.of holes	<b>T</b>	V	Cable gland
St 1.ZK 71	2,4,6,8	FF 130	140	147	<b>14</b>	14	<b>30</b>	30	<b>5</b>	5	<b>16</b>	16	278	12	310	<b>130</b>	<b>110</b>	<b>160</b>	<b>10</b>	4	<b>3,5</b>	227	Pg 13,5
St 1.ZK 80	2,4,6,8	FF165	154	156	<b>19</b>	19	<b>40</b>	40	<b>6</b>	6	<b>21,5</b>	21,5	316	14	358	<b>165</b>	<b>130</b>	<b>200</b>	<b>12</b>	4	<b>3,5</b>	256	Pg 13,5
St 1.ZK 90	S	FF 165	170	192	<b>24</b>	24	<b>50</b>	50	<b>8</b>	8	<b>27</b>	27	370	16	422	<b>165</b>	<b>130</b>	<b>200</b>	<b>12</b>	4	<b>3,5</b>	292	Pg 13,5
	L																						
St 1.ZK 100	L	FF 215	193	198	<b>28</b>	28	<b>60</b>	60	<b>8</b>	8	<b>31</b>	31	432	18	494	<b>215</b>	<b>180</b>	<b>250</b>	<b>15</b>	4	<b>4</b>	323	Pg 13,5
	Ld																						
St 1.ZK 112	M	FF 215	216	215	<b>28</b>	28	<b>60</b>	60	<b>8</b>	8	<b>31</b>	31	435	18	497	<b>215</b>	<b>180</b>	<b>250</b>	<b>15</b>	4	<b>4</b>	340	Pg 21
St 1.ZK 132	Sk	2	FF 265	247	<b>38</b>	38	<b>80</b>	80	<b>10</b>	10	<b>41</b>	41	535	18	617	<b>265</b>	<b>230</b>	<b>300</b>	<b>15</b>	4	<b>4</b>	378	Pg 21
	S	2,4,6,8																					
	Mk	6																					
	M	4,6,8																					

Mounting dimensions given in bold figures are obligatory in the sense of IEC recommendations.

Type: **St 1.ZK**  
 Protection: **EExd I, EExde II B**  
 Temperature class: **T1 - T4**

**IM B3 - IM 1001**

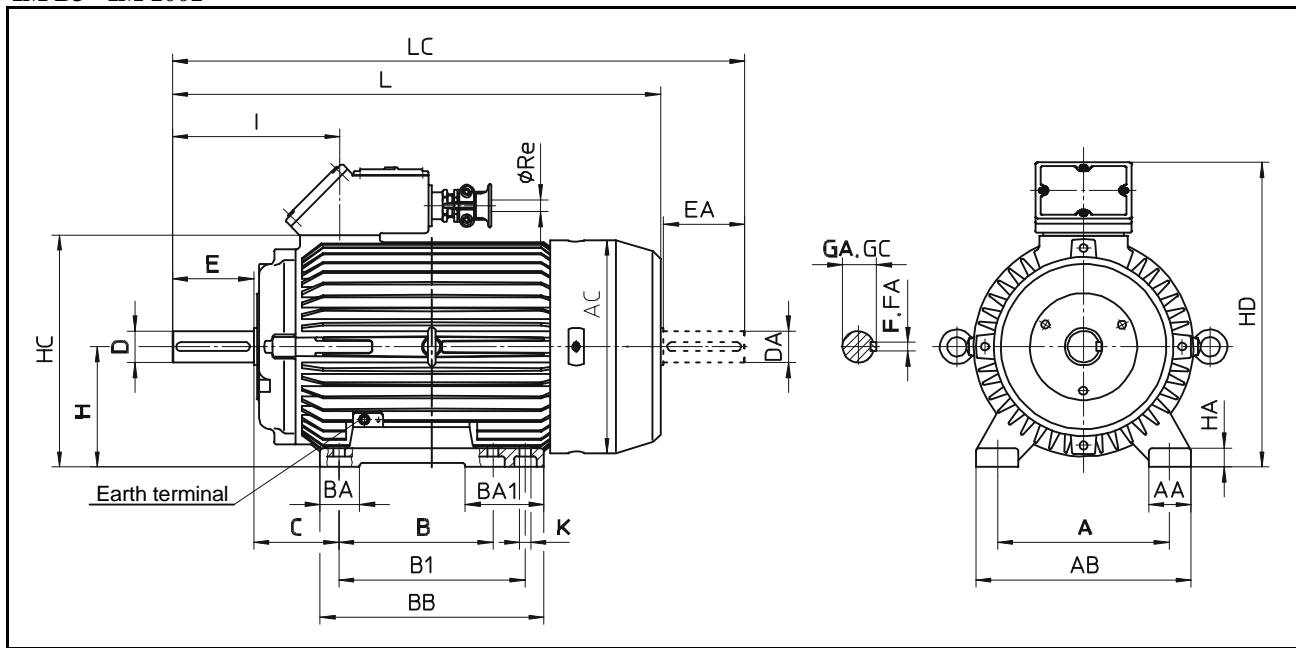

Type	Pole	A	AA	AB	AC	B	B1	BA	BA1	BB	C	D	DA	E	EA	F	FA	GA	GC	H	HA	HC	HD	I	K	L	LC	Cable gland with trumpet			
St 1.ZK 160	Mk	2,8				<b>210</b>	-																								
	M	<b>254</b>	60	314	285			65	103	304	<b>108</b>	<b>42</b>	42	<b>110</b>	110	<b>12</b>	12	<b>45</b>	45	<b>160</b>	23	268	385	175	<b>15</b>	670	790		Re 29		
	L	2,4,6,8																													
St 1.ZK 180	M	2,4	<b>279</b>	70	349	323	<b>241</b>	-																							Re29
	L	4,6,8																													
St 1.ZK 200	Lk	2,6	<b>318</b>	80	398	369	-	<b>305</b>	95	95	375	<b>133</b>	<b>55</b>	55	<b>110</b>	110	<b>16</b>	16	<b>59</b>	59	<b>200</b>	30	423	534	272	<b>18</b>	826	951		Re 36	
	L	2,4,6,8																													
St 1.ZK 225	S	4,8				<b>286</b>	-						<b>60</b>	60	<b>140</b>	140	<b>18</b>	18	<b>64</b>	64					264		860	1015			
	M	2	<b>356</b>	90	446	411			84	100	380	<b>149</b>	<b>55</b>	55	<b>110</b>	110	<b>16</b>	16	<b>59</b>	59	<b>225</b>	35	455	590	234	<b>18</b>	830	955		Re 36	
		4,6,8												<b>60</b>	60	<b>140</b>	140	<b>18</b>	18	<b>64</b>	64				264		860	1015			
St 1.ZK 250	M	2	<b>406</b>	96	506	474	-	<b>349</b>	95	133	430	<b>168</b>	<b>60</b>	60	<b>140</b>	140	<b>18</b>	18	<b>64</b>	64	<b>250</b>	40	543	723	340	<b>24</b>	940	1095		Re 36	
		4,6,8												<b>65</b>	65	<b>140</b>	140	<b>18</b>	18	<b>69</b>	69										
St 1.ZK 280	S	2				<b>368</b>	-						<b>65</b>	65			<b>18</b>	18	<b>69</b>	69											
		4,6,8	<b>457</b>	110	567	510			110	150	500	<b>190</b>	<b>75</b>	75			<b>20</b>	20	<b>79,5</b>	79,5	<b>280</b>	45	598	784	340	<b>24</b>	1065	1220		Re 36	
	M	2											<b>65</b>	65			<b>18</b>	18	<b>69</b>	69											
St 1.ZK 315	S	2				<b>406</b>	-						<b>65</b>	65	<b>140</b>	140	<b>18</b>	18	<b>69</b>	69					380		1170	1325			
		4,6,8	<b>508</b>	125	633	562			120	170	550	<b>216</b>	<b>80</b>	80	<b>170</b>	170	<b>22</b>	22	<b>85</b>	85	<b>315</b>	50	690	887	410		1200	1385		Re 42	
	M	2											<b>65</b>	65	<b>140</b>	140	<b>18</b>	18	<b>69</b>	69					380		1170	1325			
		4,6,8												<b>80</b>	80	<b>170</b>	170	<b>22</b>	22	<b>85</b>	85					410		1200	1385		

On a special request, motors of frame size **200** to **315** are also available in explosion-proof protection **EExd II C!**  
 On a special request, motors of frame size **160** to **315** are also available in temperature class **T5!**  
 Mounting dimensions given in bold figures are obligatory in the sense of IEC recommendations.





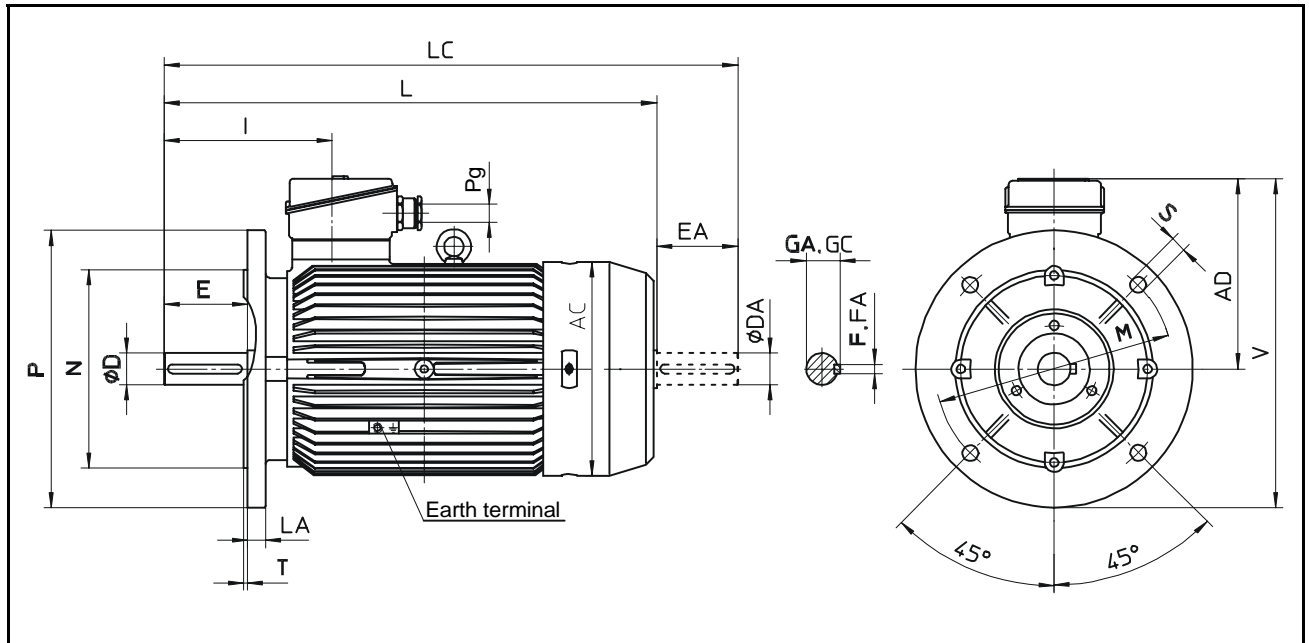

Type: **St 1.ZK**Protection: **EExde II B**Temperature class: **T1 - T4****IM B5 - IM 3001**

Type	Pole	Flange	AC	AD	D	DA	E	EA	F	FA	GA	GC	I	L	LA	LC	M	N	P	S	Num.of holes	T	V	Cable gland													
St 1.ZK 160	Mk	2,8	FF 300	285	225	42	42	110	110	12	12	45	45	175	650	23	770	300	250	350	19	4	5	400	Pg 29												
	M	2,4,6,8																																			
	L																																				
St 1.ZK 180	M	2,4	FF 300	323	275	48	48	110	110	14	14	51,5	51,5	192	706	23	826	300	250	350	19	4	5	450	Pg 29												
	L	4,6,8																																			
St 1.ZK 200	Lk	2,6	FF 350	369	334	55	55	110	110	16	16	59	59	272	806	23	931	350	300	400	19	4	5	534	Pg 36												
	L	2,4,6,8																																			
St 1.ZK 225	S	4,8	FF 400	411	371	60	60	140	140	18	18	64	64	264	860	23	995	400	350	450	18	8	5	596	Pg 36												
	M	2																								55	55	110	110	16	16	59	59	234	810	23	935
		4,6,8																								60	60	140	140	18	18	64	64	264	860	23	995
St 1.ZK 250	M	2	FF 500	474	473	60	60	140	140	18	18	64	64	340	940	25	1075	500	450	550	19	8	5	748	Pg 36												
		4,6,8																								65	65	140	140	18	18	69	69	340	940	25	1075
St 1.ZK 280	S	2	FF 500	510	504	65	65	140	140	18	18	69	69	340	1065	25	1200	500	450	550	19	8	5	779	Pg 36												
		4,6,8																								75	75	20	20	79,5	79,5						
	M	2				65	65			18	18	69	69																								
		4,6,8				75	75			20	20	79,5	79,5																								
St 1.ZK 315	S	2	FF 600	562	572	65	65	140	140	18	18	69	69	380	1170	25	1305	600	550	660	24	8	6	902	Pg 42												
		4,6,8																								80	80	22	22	85	85	410	1200				
	M	2				65	65			18	18	69	69	380	1170																						
		4,6,8				80	80			22	22	85	85	410	1200																						

On a special request, motors of frame size **200 to 315** are also available in explosion-proof protection **EExd II C!**On a special request, motors of frame size **160 to 315** are also available in temperature class **T5!**

Mounting dimensions given in bold figures are obligatory in the sense of IEC recommendations.

## 3.6 PARTS

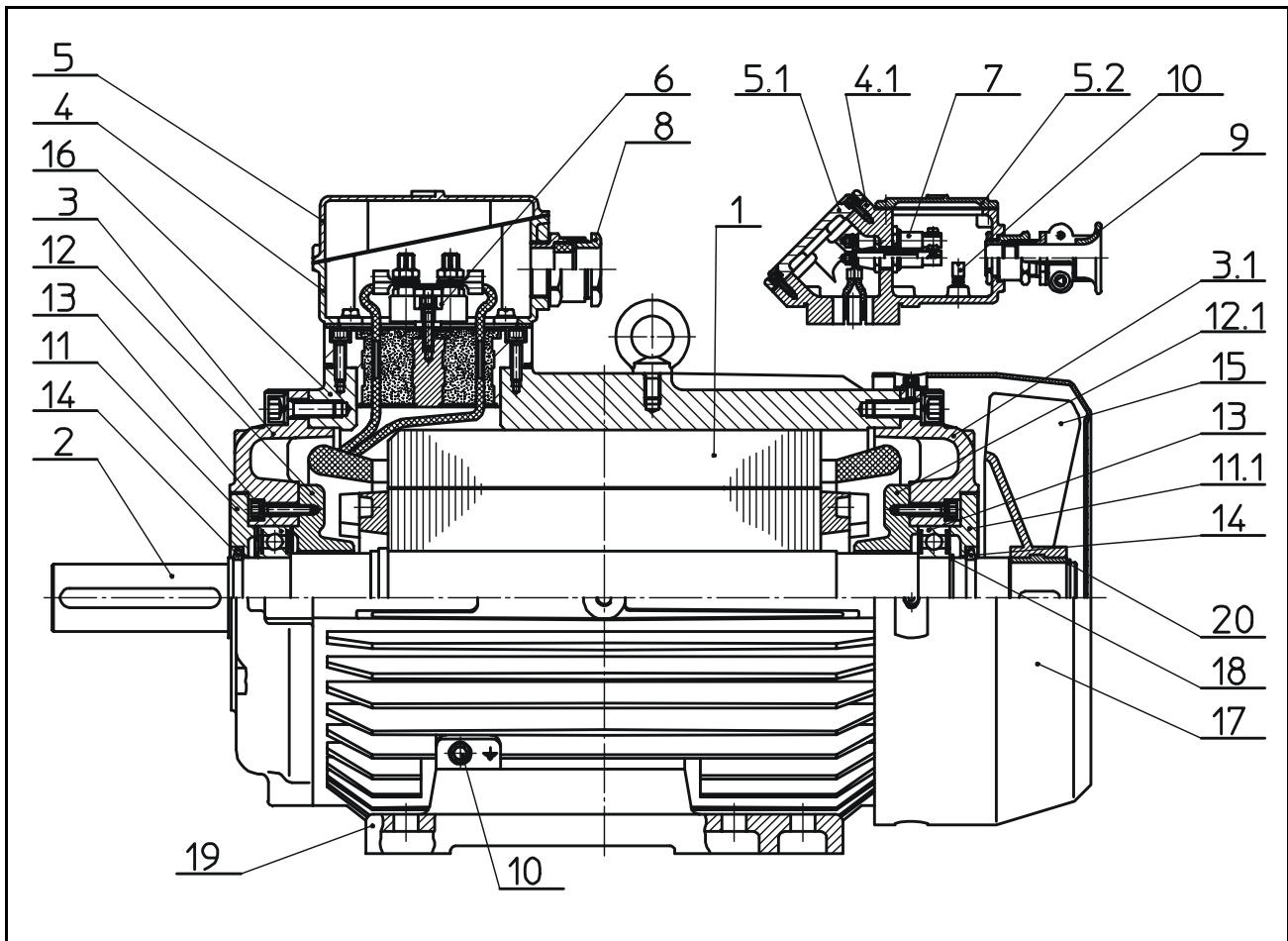

ITEM	DESCRIPTION
1.	STATOR
2.	ROTOR
3.	STATOR COVER - DRIVE SIDE
3.1	STATOR COVER - FAN SIDE
4.	TERMINAL BOX FRAME
4.1	TERMINAL BOX FRAME
5.	TERMINAL BOX COVER
5.1	TERMINAL BOX COVER
5.2	TERMINAL BOX COVER
6.	TERMINAL BOARD WITH ACCESSORIES
7.	FLAMEPROOF BUSHING
8.	CABLE GLAND
9.	CABLE GLAND WITH TRUMPET
10.	EARTH TERMINAL
11.	BEARING COVER, EXTERNAL - DRIVE SIDE
11.1	BEARING COVER, EXTERNAL - FAN SIDE
12.	BEARING COVER, INTERNAL - DRIVE SIDE
12.1	BEARING COVER, INTERNAL - FAN SIDE
13.	BEARING
14.	SHAFT SEAL
15.	FAN
16.	INTERPLATE OF TERMINAL BOX
17.	FAN COVER
18.	CIRCLIP
19.	FOOT
20.	CIRCLIP

## Company locations

### HEAD OFFICE AUSTRIA

#### ATB Austria Antriebstechnik AG

Renngasse 6-8  
1010 Wien, Austria

T: +43 1 90 250 - 0  
F: +43 1 90 250 110

info@atb-motors.com  
www.atb-motors.com

### AUSTRIA

#### ATB Motorenwerke GmbH

G.-Bauknecht-Str. 1  
8724 Spielberg  
T: +43 3577 757-323  
F: +43 3577 757-182  
info@atb-motors.com

#### ATB Technologies GmbH

Millenium Park 11  
6890 Lustenau  
T: +43 5577 9010-0  
F: +43 5577 9010-110  
info@atb-motors.com

### ASIA

#### ATB Motorentechnik GmbH

141 Market Street,  
# 07-01 International Factors  
Building  
Singapore 048944  
T: +65 63721174  
F: +65 62253524  
dennis.tan@atbs.com.sg

### BAHREIN

#### ATB Austria Antriebstechnik Aktiengesellschaft, Rep. Office Bahrain

Almoayyed Tower  
21st Floor c/o Regus  
Seef District, Manama  
Kingdom of Bahrain  
T: +973 175 68 160  
F: +973 175 67 901

### BENELUX

#### ATB BeNeLux B.V.

Tasveld 14  
8271 RW IJsselmuiden  
T: +31 38 443 2110  
F: +31 38 443 2111  
verkoop@nl.atb-motors.com

### GERMANY

#### ATB Antriebstechnik GmbH

Silcherstraße 74  
73642 Welzheim  
T: +49 7182 14-535  
F: +49 7182 14 590  
info@de.atb-motors.com

#### ATB Motorentechnik GmbH

Helgoländer Damm 75  
26954 Nordenham  
T: +49 4731 365-0  
F: +49 4731 365-159  
info@de.atb-motors.com

#### Schorch Elektrische Maschinen und Antriebe GmbH

Breite Straße 131  
41238 Mönchengladbach  
T: +49 2166 925-0  
T: +49 2166 925-100  
mail@schorch.de

### POLAND

#### Fabryka Silników Elektrycznych Tamel S.A.

ul. Elektryczna 6  
33 100 Tarnow  
T: +48 14 632 11 00  
F: +48 14 632 11 02  
officetamel@tamel.pl

### RUSSIA

#### ATB Rus 000

Petrovka ul. 27  
107031 Moscow  
T: +7 495 95 66 326  
vyacheslav.mikheyev@a-tecindustries.com

### SERBIA

#### ATB SEVER D00 SUBOTICA

Magnetna polja 6  
24000 Subotica  
T: +381 24 665 100  
F: +381 24 546 893  
sever@rs.atb-motors.com

#### ATB FOD d.o.o.

Dorda Vajfert 16  
19210 Bor  
T: +381 30 423 147  
fod@fod.co.rs

### SWITZERLAND

#### ATB Schweiz AG

Industriestraße 28  
5600 Lenzburg  
T: +41 62 885 70-10  
info@ch.atb-motors.com

### UK & IRELAND

#### ATB Laurence Scott Ltd.

PO Box 25 Hardy Road, Norwich NR1 1JD  
Norfolk  
T: +44 1603 628 333  
hvm.sales@laurence-scott.com

#### ATB Morley Limited

Bradford Road  
Leeds LS28 6QA  
West Yorkshire  
T: +44 113 257 1734  
sales@uk.atb-motors.com

#### Brook Crompton UK

St. Thomas Road, Huddersfield HD1 3LJ  
West Yorkshire  
T: +44 1484557200  
F: +44 1484557201  
csc@brookcrompton.com

### CANADA

#### Brook Crompton

North America  
264 Attwell Drive  
M9W 5B2 Toronto, Ontario  
T: +1 416 675-3844  
ramzi.mallouk@brookcromptonna.com

**ATB SEVER DOO SUBOTICA**

Magnetna polja 6

24 000 Subotica

Serbia

Tel. +381 24 665-124

Fax +381 24 665-125

[www.atb-motors.com](http://www.atb-motors.com)

[sever@rs.atb-motors.com](mailto:sever@rs.atb-motors.com)